



LP Gas to Natural Gas Conversion Kit

THIS CONVERSION KIT MUST BE CONVERTED BY A QUALIFIED GAS FITTER/ SERVICE COMPANY. IF YOU DO NOT UNDERSTAND HOW TO COMPLETE THIS PROCESS THEN DO NOT CONVERT THIS APPLIANCE!

PRECAUTION: Check your fire pit installation manual to ensure you the correct orifice number for your fire pit.

This LP to NG Kit contains the following: 1 - OAS-NG# (Brass orifice)

1. Turn the fire pit and main gas supply OFF.
2. Ensure the fire pit is cool before converting.
3. Remove all media from the burner pan.
4. Remove the burner pan from the enclosure
5. Disconnect the 1/2" flex connector from the OAS-LP#.
6. Remove the 1/2" NPT Female to Male flared fitting from the old OAS-LP# (see figure 1).
7. Remove the old OAS-LP#. NOTE: Brass nut and large washer will remain attached.
8. Apply Teflon tape or pipe compound resistant to all gasses to burner threads.
9. Install the new OAS-NG#.
10. Apply Teflon tape or pipe compound resistant to all gasses to the OAS-NG# threads.
11. Install the 1/2" NPT Female to Male flared to the new OAS-NG# (See figure 2).
12. Ensure an LP regulator is installed at the main gas supply before operating.
13. Check all gas connections for leaks before and during operation with soapy water.
14. Conversion is now complete.

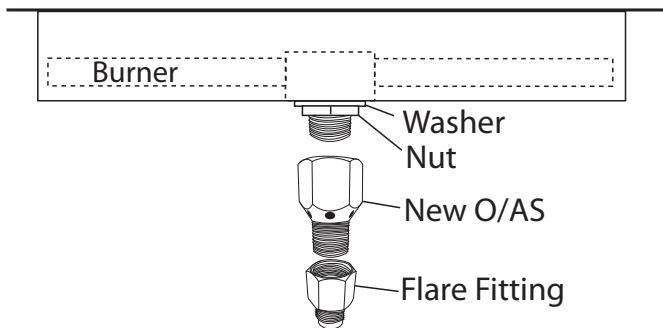

Fig. 1 Removing old LP gas orifice

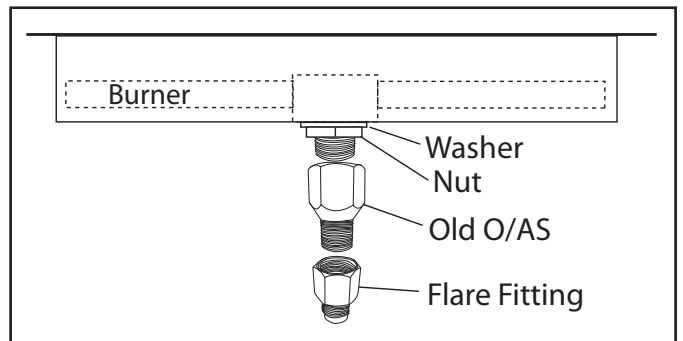

Fig. 2 Installing new Natural gas orifice

NOTE: Natural gas orifices have no air inlet holes and LP gas orifices have air inlet holes to provide a cleaner burning of the gas.

For Techincal Service Call: (855) 498-8324

Firegear Outdoors
9230 Conservation Way
Fort Wayne, IN 46809
For Sales: (888) 672-8929
Web Site: www.firegearoutdoors.com

REV. 6-18-15