

PRIME®

GO-POWER™

AUTO IGNITION POWER BANK

PPBBC7500S

MANUAL

IMPORTANT INSTRUCTION

1. To ensure the jump starter can be normally used in emergency, we highly suggest you check and recharge it in every one month.
2. It can be used for vehicle engine displacements for petrol under 3.5L or under diesel 2.5L.
3. It is better to shut down all devices (e.g., air conditioner, headlight) in the car before jump start.
4. The product can not be continuous to start the car, it may cause damage to the product. Each time you start the interval must be longer than 30 seconds, and if 2 times not success, then stop starting.

Smart All-in-1

Smart jump-start cable



[Features]

- ★ Maximum 400Amp of loading current
- ★ Output short-circuit and reverse-current protection
- ★ Wrong output-polarity protection and alert
- ★ Wrong output-polarity protection
- ★ Low-voltage protection for power bank
- ★ Self-diagnosis and error alarm
- ★ LED indicator for operation
- ★ Spark free
- ★ Positive temperature coefficient
- ★ Manual-mode

Polarity Reverse Protection:

- 1. Buzzer alert
- 2. no spark
- 3. Car computer protection

◆ Instruction

1. Connect the jump-start cable with output for starting vehicle
2. Connect the battery clamps with car battery
3. Press the switch button for 1 second
4. The power indicator (blue light) will be on
5. The (in action) green light will be on
6. Start the engine
7. Remove the clamps when starting is successful



FAQ :

Q1: why buzzer alarms when clamps connect car battery?

A1: because of polarity reverse, please re-connect clamps correctly.

Q2: while device is connected, why can't switch on the power when press switch button?

A2: due to low battery of power bank, Low-voltage protection for power bank will be mode on.

Q3: how to turn off the blue light?

A3: when no load for 3-5 minutes, the device will shut down automatically.

Q4: while device is connected with power bank but isn't connected with car battery, why does buzzer alarm?

A4: due to Self-diagnosis and error alarm, it indicates that protection IC is broken. The device must be fixed.

Q5: while device is connected with car battery but isn't connected with power bank, why does buzzer alarm?

A5: due to Self-diagnosis and error alarm, it indicates that polarity reverse protection IC is broken. The device must be fixed.

Q6: when finish starting the car, does it make damages to power bank if don't remove the jump-start cable.

A6: Smart All-in-1 smart jump-start cable has reverse-current protection, so it won't cause any damage to power bank.

Q7: Why does follow the standard instruction but only blue light on?

A7: it means that the car battery is broken or ran out. Press the button of manual-mode for 3 seconds, when green light is on (only in 10 seconds), you can start the car.

Q8: Why does follow the standard instruction but still can't start the car?

A8: it means the car need higher voltage to start , shut down the power bank and car battery for a minute and connect it latter, press the switch button for a while and manual-mode button, when you see the blue light and green light is not flashing, you can start the car (start the car in 10 seconds, this period is the most powerful.). If still can't start the car, for the low battery, please change the power bank.

Specifications:

Input: Micro USB 5V 1.2A

Output: USB 5V 2A

Capacity: 7500mAh

Starting Current: 320A

Peak Current: 800A

Dimension: 5" x 3" x 1"

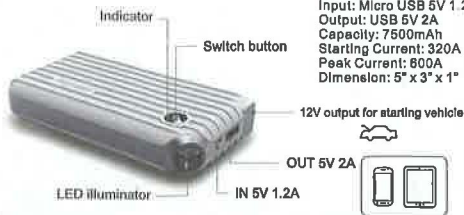

Instruction

1. Charge the device before the first time used.
2. Input and Output: use the data cable with micro USB connector and put the micro USB connector into the device's 5V Input, connect the other end of the data cable to the charger to charge the device. Use the data cable with USB connector and put the USB connector into the device's 5V output, connect the other end of the data cable to the digital device, then press the switch bottom, and it begins charging. (charge and discharge can't be in the same time)
3. Other function: LED Illuminator, press the switch button twice to activate LED flasher, and then 3 modes of LED light appear in sequence (strobe, slow flashing, fast flashing, red and blue flashing, off) if you press lightly. Also, you can press the button twice directly to off the LED flasher.
4. Power Indication comparison table: press the button once to show the indication, if there is no load, device will shut down automatically.

Indicator	one light	two light	three light	four light
Corresponding Power	>25%	25%-50%	50%-75%	75%-100%

※ How to Jump Start a 12V car ※

When a vehicle's battery voltage is too low to start the engine, take this device and battery clamps, connect the red battery clamp  with car battery positive $+$ while black clamp  with negative $-$ side of the car battery. Insert the plug of battery clamps into jump starter and you can start the car. (battery clamps must be correctly connected.)

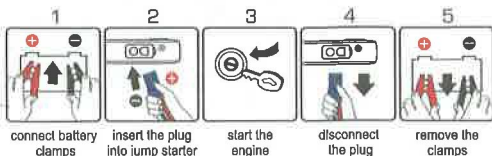

When you need jump start, it can start the car while there are 3 or more indicator lights on. To keep the best battery life, please make sure to charge the device after jump starting.

Warning

- If the cable can't work on charging, please make sure the cable with USB/micro USB connector is put into input/output correctly, or you can use your own cable.
- Please make sure the device is suitable placed, to avoid bump, and don't disassemble device by yourself or pierce the device. Make sure it is far from fire, high temperature and water. If you find the device is expanded or abnormal, please stop using device immediately.
- Operating temperature: 10-45 degrees Celsius.