

## TROUBLESHOOTING

	PROBLEM / SOLUTION
THE PUMP DOES NOT WORK	<p>THERE MAY NOT BE AN ELECTRICAL CURRENT RUNNING TO THE DEVICE. CHECK TO MAKE SURE DEVICE IS PLUGGED IN PROPERLY. MAKE SURE THE SWITCH ASSOCIATED WITH THE ELECTRICAL OUTLET WHICH THE DEVICE IS PLUGGED INTO IS TURNED ON. CHECK TO MAKE SURE THERE IS NO SIGNS OF DAMAGE TO THE ELECTRICAL CORD.</p> <p>PUMP MOTOR MAY HAVE SEIZED - WITHOUT BEING FULLY SUBMERGED IN WATER. THE PUMP WILL RUN DRY AND CAUSE DAMAGE TO THE PUMP MOTOR. REPLACEMENT MAY BE NECESSARY.</p>
THE FLOW RATE HAS REDUCED	<p>THE FILTER BASKET MAY BE CLOGGED - OVER TIME, LARGE DEBRI MAY GET STUCK ON THE INTERIOR AND EXTERIOR OF THE FILTER BASKET HINDERING WATER INTAKE. REMOVE THE FILTER BASKET AND GENTLY CLEAN ALL DEBRI.</p> <p>FILTER SPONGE MEDIA MAY BECOME CLOGGED OVER TIME. THE FILTER SPONGE MEDIA WILL GET DIRTY AND PREVENT MAXIMUM WATER FLOW. REMOVE THE FILTER BASKET TO EXPOSE THE FILTER SPONGE MEDIA AND REPLACE WITH NEW ONE.</p>



## PRODUCT SPECIFICATION

MODEL	IFE - 10	IFE - 20	IFE - 30
TANK CAPACITY	20 GALS	40 GALS	40 GALS
FLOW RATE	80 GPH	170 GPH	170 GPH
PUMP POWER	6 WATTS	11 WATTS	11 WATTS
MEDIA COMPARTMENT	4	3	5

# IFE | SERIES

INTERNAL FILTER  
WITH SPRAY BAR

## INTRO - IFE 10 / IFE 20 / IFE 30

THANK YOU FOR CHOOSING AQUATOP'S SERIES OF INTERNAL FILTERS WITH SPRAY BAR. THIS INNOVATIVE AND FLEXIBLE DESIGN IS PERFECT TO HELP YOU CONTROL HARMFUL WASTE FROM THE WATER, ELIMINATE ODOR, AND ENHANCE WATER CLARITY.

THE IFE SERIES FILTER WITH SPRAY BAR USES AN INTERNAL PUMP TO MOVE WATER PAST MULTIPLE FILTRATION COMPARTMENTS WHICH ALLOWS YOU TO HAVE THE THREE NEEDED FORMS OF FILTRATION. MECHANICAL FILTRATION CAN BE DONE WITH AN AQUATOP FILTER SPONGE OR FILTER COTTON. CHEMICAL FILTRATION CAN BE DONE WITH AQUATOP'S BAMBOO CARBON. BIOLOGICAL FILTRATION CAN BE DONE USING AQUATOP'S CERAMIC RINGS.

THE EFFICIENT DESIGN ALLOWS AQUATOP'S IFE TO BE FULLY SUBMERGED IN BOTH FRESH AND SALTWATER AQUARIUMS. WITH ITS FLEXIBILITY, IT CAN BE PLACED ANYWHERE IN YOUR AQUARIUM, SUMP TANK OR EVEN IN YOUR GARDEN POND. THE DESIGN ALLOWS FOR EASY INSTALLATION AND MAINTENANCE.

PLEASE REFERENCE THIS MANUAL FOR ANY QUESTIONS AND INSTRUCTIONS FOR USE. MAY AQUATOP'S IFE SERIES SERVE YOU AND YOUR AQUATIC LIFE WELL.

## INSTRUCTIONS FOR USE

THE IFE SERIES FILTER IS EXTREMELY FLEXIBLE AND ALLOWS FOR PLACEMENT ANYWHERE IN YOUR AQUARIUM OR POND. MAKE NOTE THAT THE IFE NEEDS TO BE SUBMERGED UNDERWATER TO PROVIDE MAXIMUM FILTRATION EFFECTIVENESS AND TO HELP PRESERVE THE PRODUCT'S LIFE.

## ASSEMBLY AND PARTS LIST FOR THE IFE SERIES

### IFE 10 / IFE 20 / IFE 30

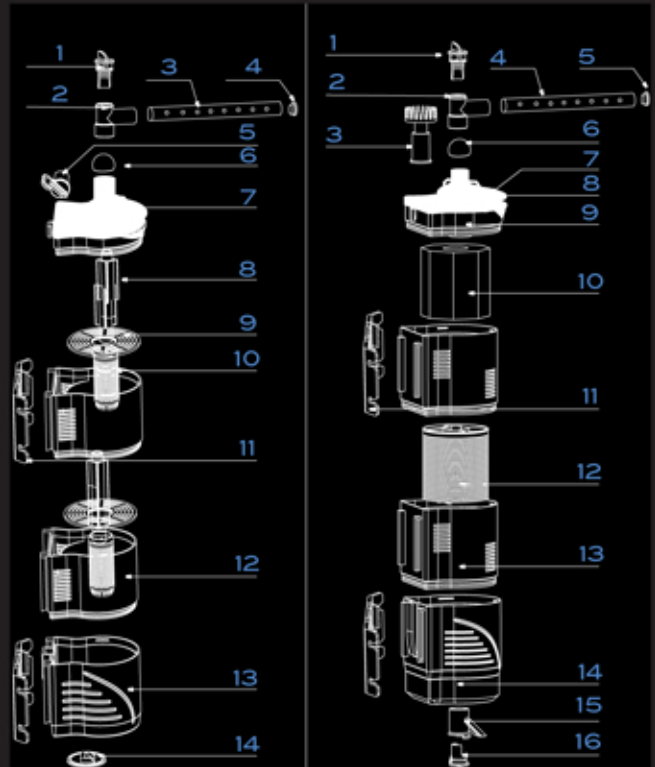
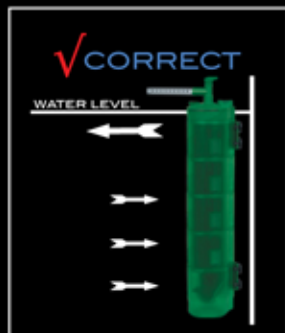

FIG 1



### IFE - 10

1	SPRAY BAR VALVE
2	TEE CONNECTOR
3	SPRAY BAR
4	SPRAY BAR END CAP
5	PUMP FLOW VALVE
6	FILTER CAP
7	FILTER LID
8	INSIDE TUBE
9	BASKET CAP
10	BASKET CYLINDER
11	FILTER MOUNT
12	MEDIA COMPARTMENT
13	MEDIA COMPARTMENT
14	BOTTOM CAP

### IFE - 20 / IFE - 30

1	SPRAY BAR VALVE
2	TEE CONNECTOR
3	SURFACE SKIMMER
4	SPRAY BAR
5	SPRAY BAR END CAP
6	FILTER CAP
7	WATER OUTLET
8	PUMP FLOW VALVE
9	FILTER LID
10	SPONGE FILTER
11	FILTER MOUNT
12	MEDIA BASKET
13	MEDIA COMPARTMENT
14	MEDIA COMPARTMENT
15	FLOW ADJUSTER
16	BOTTOM CAP