

Leverhoists.com

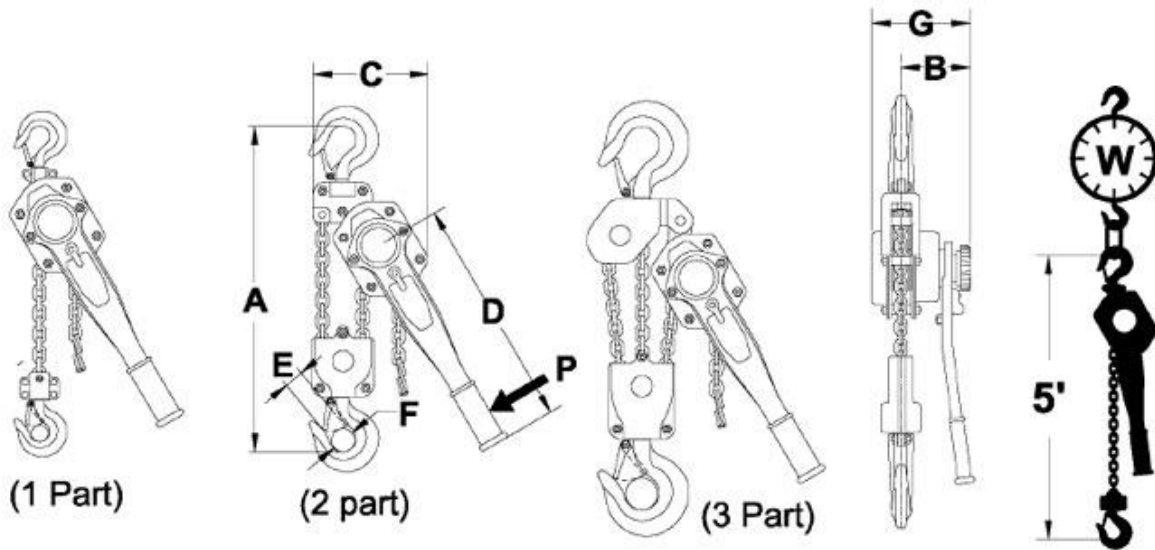

LA SERIES SPECIFICATIONS and DIMENSIONS

(inches and pounds, unless noted)

Base Model	(WLL) Working Load Limit				Chain	Parts	A" Min.	B"	C"	D"	E"	F"	G"	P (lbs)	W (lbs) /Ft.Lift	W(1) (lbs) 5' Lift
	US Ton	Metric Tonne	* Min Lbs	Load Kg												
LA008	3/4+	0.8	44	20	C6X18Z	1	13.4	3.9	5.2	10.5	1.02	0.98	6.2	47	0.54	14.9
LA010	1+	1.0	44	20	C6X18Z	1	13.4	3.9	5.2	12.1	1.02	0.98	6.2	51	0.54	15.3
LA016	1 3/4	1.6	70	32	C7X21Z	1	15.7	4.4	5.7	14.0	1.14	1.18	7.2	66	0.74	24.1
LA020	2 1/4	2.0	88	40	C8X24Z	1	18.1	4.6	7.6	14.0	1.38	1.30	8.1	66	0.92	36.2
LA025	2 3/4	2.5	110	50	C9X27Z	1	19.1	4.6	7.6	14.0	1.38	1.30	8.1	74	1.25	37.9
LA032	3 1/2	3.2	141	64	C10X28Z	1	20.5	4.8	7.8	16.5	1.46	1.42	8.3	72	1.50	44.8
LA063	7	6.3	278	126	C10X28Z	2	25.2	4.8	9.1	16.5	1.69	1.69	8.3	74	3.00	66.3
LA090	10	9.0	396	180	C10X28Z	3	28.7	4.8	13.3	1.85	1.69	1.73	8.3	76	4.50	110.6

***Minimum Load** is the load required to activate the automatic load brake.

(1) Shipping weight can be estimated by adding approx, 15% to "W" hanging weight

Standard lift is 5, 10, 15 and 20 Ft.