

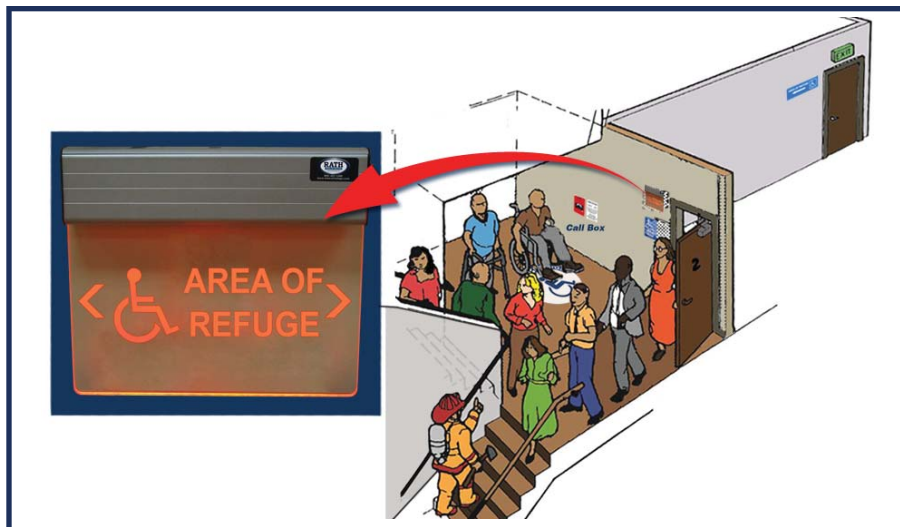

# Area of Refuge Sign 7050/7050D



## **Features:**

- Single sided (7050)
- Double sided (7050D)
- Mounts to any surface (4 screw holes)
- Power: 120/277vac (4w, 350mA)
- Voltage surge and short circuit protection
- Battery backup
- LED lights
- Constant uniform illumination
- White aluminum housing with acrylic surface
- Sign should be mounted above 60" but below 80" from the floor to top of the sign
- Directional arrows included (set of 3)
- UL listed to meet UL 924, NEC, OSHA, NFPA, and Life Safety Code Illumination requirements