

# CMR

## OPEN CHANNEL RACK DESIGN FOR EASY CABLE INSTALLATION & ROUTING

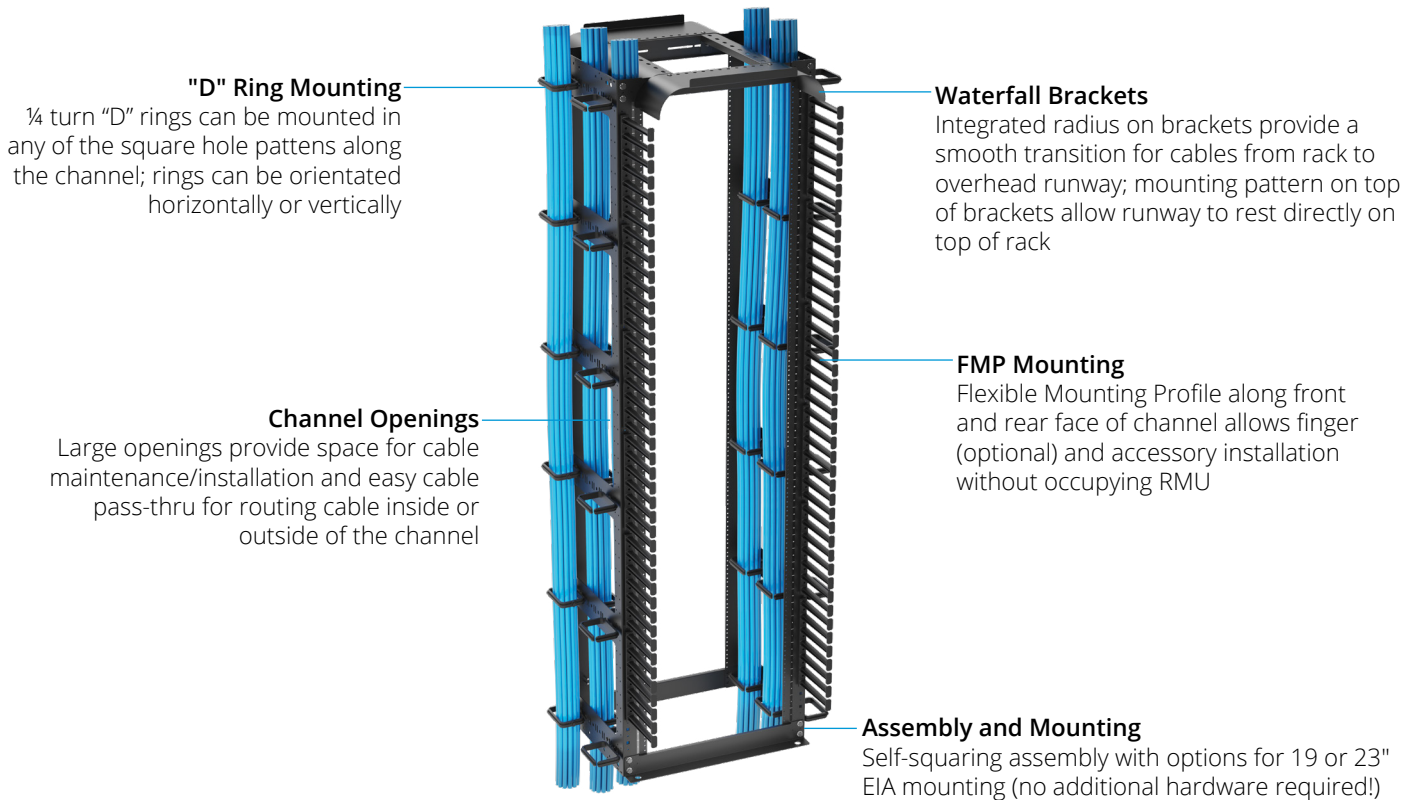

Height	Depth	Color	Mounting	Example
CMR-XXU	XX-	X-	XXX-	Configured CRMX
45	06 (6")	B (Black)	1224 (tapped 12-24)	CMR-45U06-B-1224
52	10 (10.5")	W (White)	SQM6 (3/8" sq. M6)	
59	12 (12")			
	16 (16.25")			

### FEATURES

- #12-24 tapped or 3/8" sq. (M6) channels (with RMU markings) for 19" and 23" mounting
- Includes 20, 1/4 turn "D" rings, 3.5" x 5"
- Large channel openings support side-to-side airflow and allow cable pass-thru
- Four top waterfall brackets with 3" bend radius; two fixed, two adjustable
- Cable runway or basket tray can rest directly on top of the rack or can be supported by optional ladder rack brackets
- Weight capacity 2500 lbs.
- Standards: UL2416, RoHS II

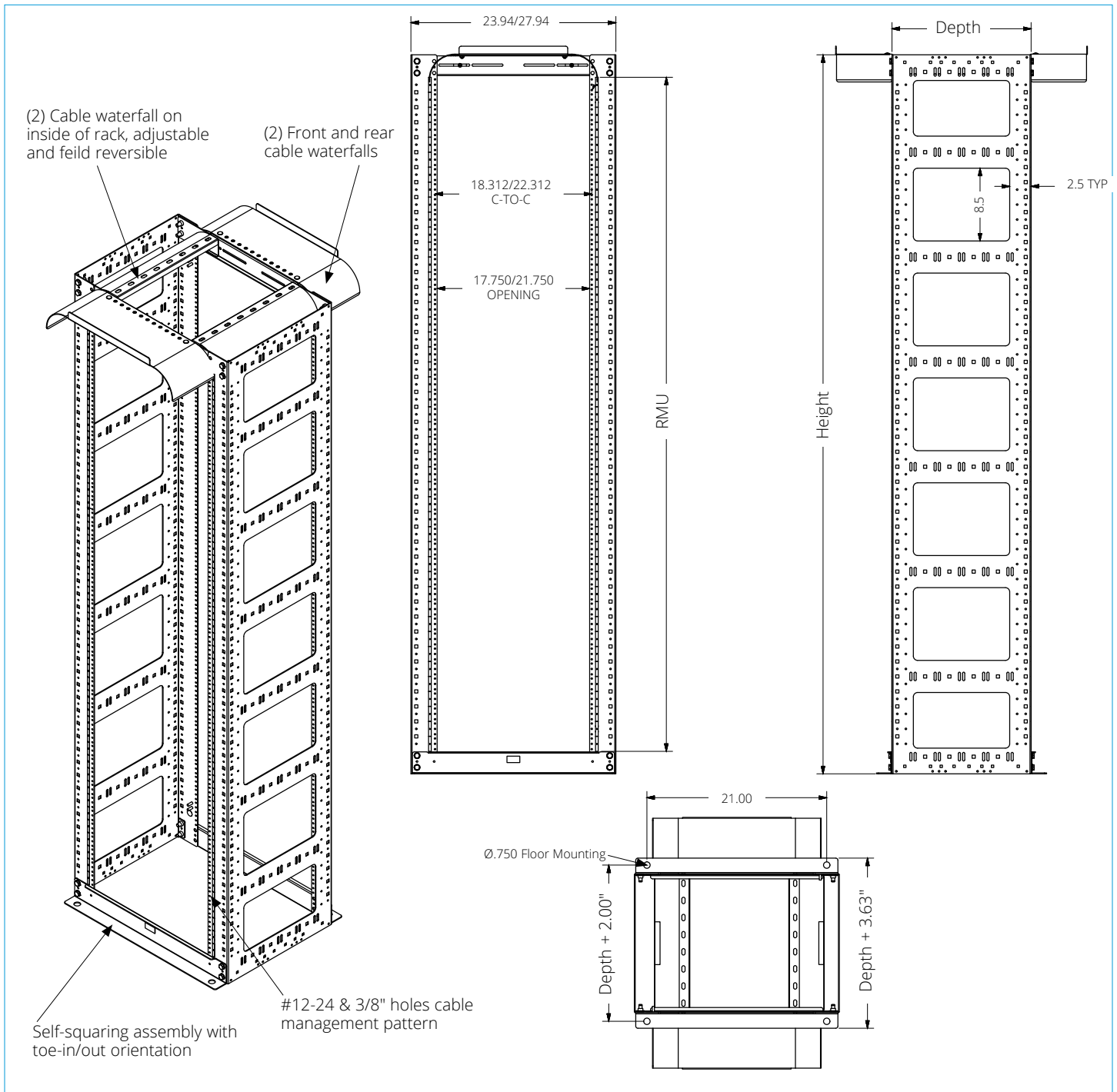

## POPULAR ACCESSORIES

Part No.	Description
ESC-K12-7	7" x 7 RMU, set of 12 finger sections; mount along FMP
CM-11	3"W x 5"D, set of five rings; mount along FMP
CM-25	1.5" x 3.5", set of 10 rings; mount along rack uprights
CM-26	3.5" x 5", set of 10 rings; mount along rack uprights
PDU2	One pair of brackets with 2 mounting positions for PDUs; mount along FMP
VPCB1	84" Single power cable bar; mount along FMP
Vertical Cable Managers	Front only and front/rear VCMs available