

# Assembly Instructions

for Y10600, Y10601, Y10602, Y10603,  
Y10606 and Y10607

reception desks. Also, standing height  
reception desks Y10610, Y10611 and Y10612

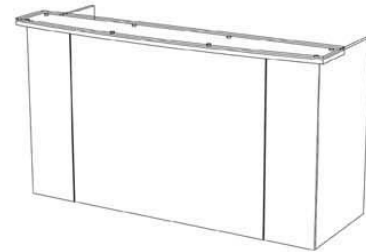

## Tips:

- Assemble in carpeted area for protection during assembly or use cardboard packaging for protection.
- Allen wrench for hardware has been provided.
- Depending on the model of desk you purchased, some of these steps need not apply.

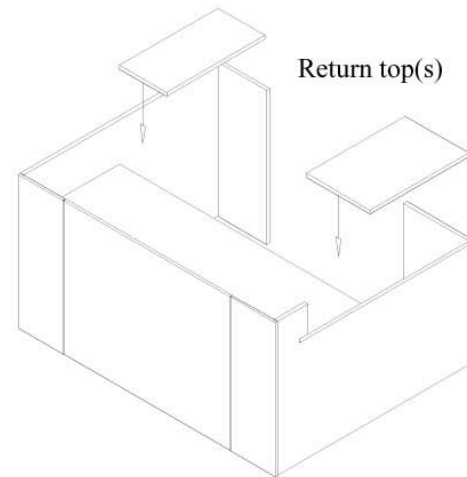
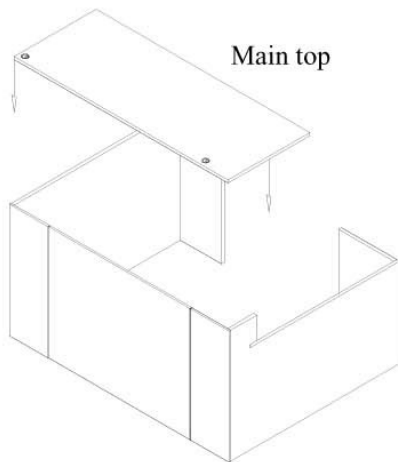
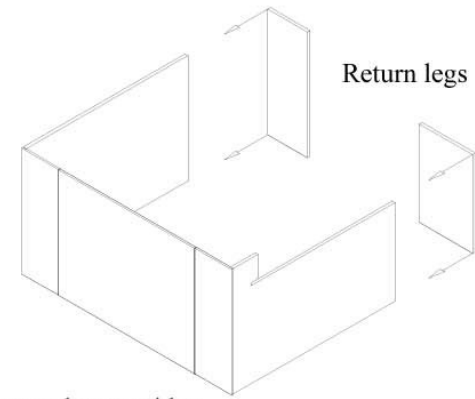
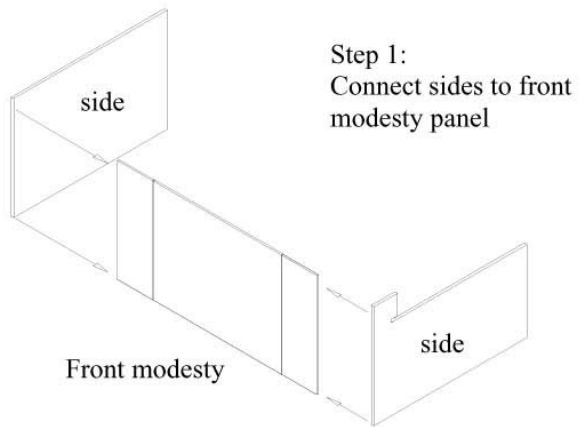

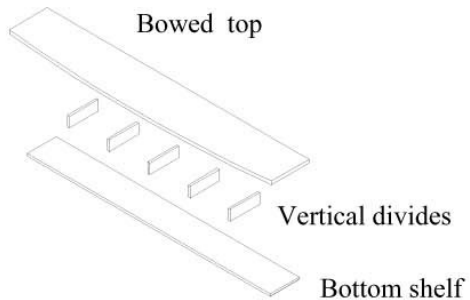

Step 5:  
Assemble main transaction top.

Assembled main transaction top

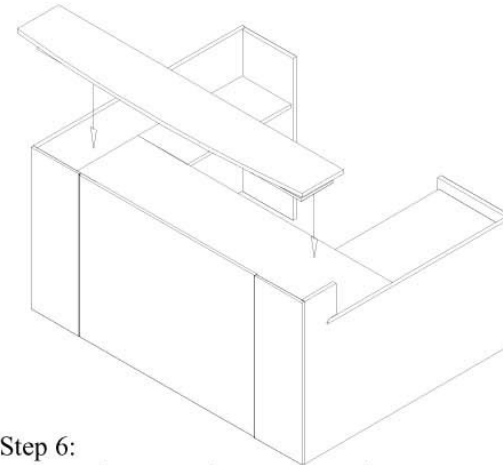

Step 6:  
Drop main transaction top onto pins on sides and front modesty.

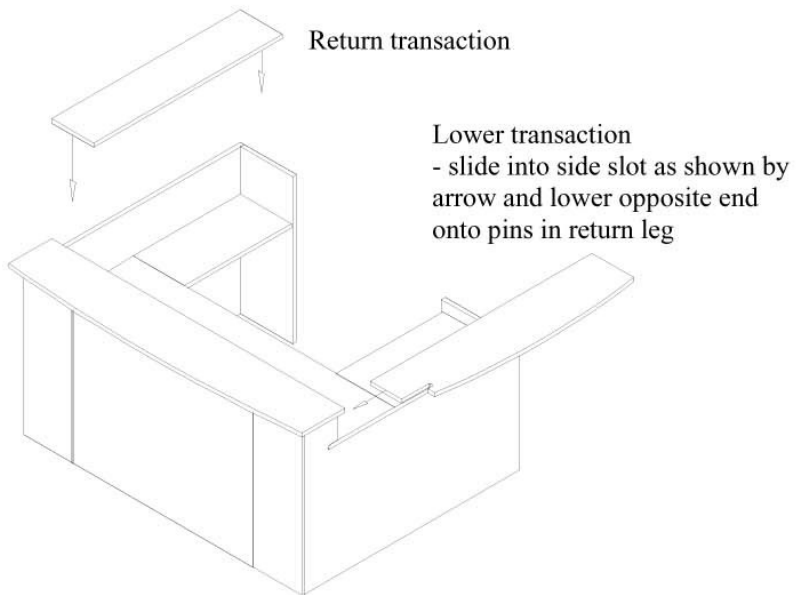

Step 7:  
Install lower transaction and return transaction top(s) as shown.  
(only applicable for L & U-desks)

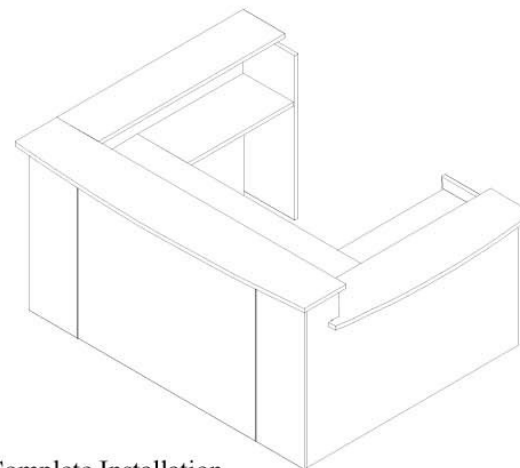

Complete Installation  
level and install pedestals and accessories