

Y11916 - Reception Desk Assembly Instructions

Tools Needed: Phillips Screwdriver & A Helper!

Step 1: Insert three L Front Panel Supports with G Dowels into vertical support panel.

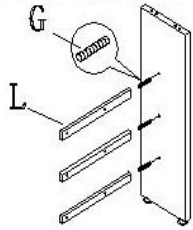

1

Step 2: Insert H Leveling Glides into vertical support.

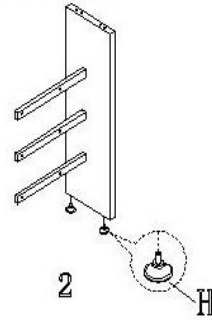

2

Step 3: Attach K Strip with two E Screws, then insert six C Screws to connect L Supports.

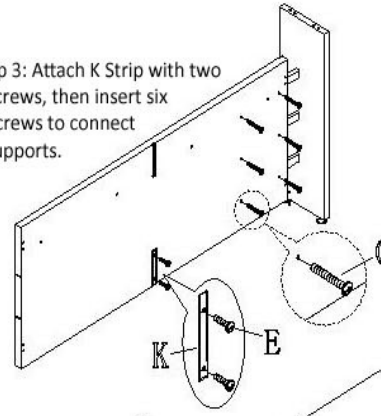

3

Step 4 - Attach J Legs with two E Screws each, to the Left & Right side panels. Then insert A Cam Pins as shown.

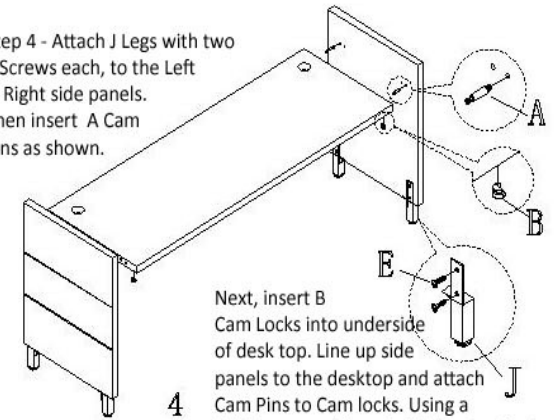

4

Next, insert B Cam Locks into underside of desk top. Line up side panels to the desktop and attach J Cam Pins to Cam locks. Using a Phillips screwdriver, twist the Cam Locks to secure connection.

Step 5: Attach Front Panel of desk to the desktop/side panel assembly using A Cam Pins and B Cam Locks as shown.

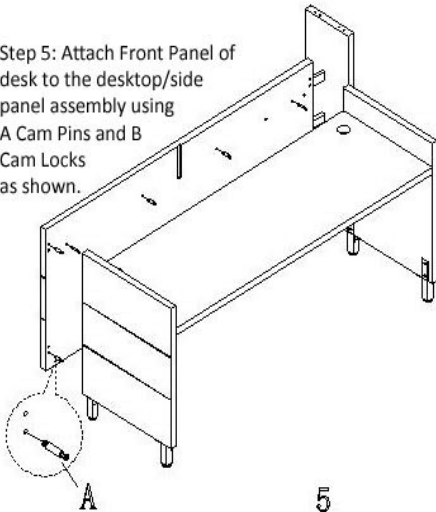

5

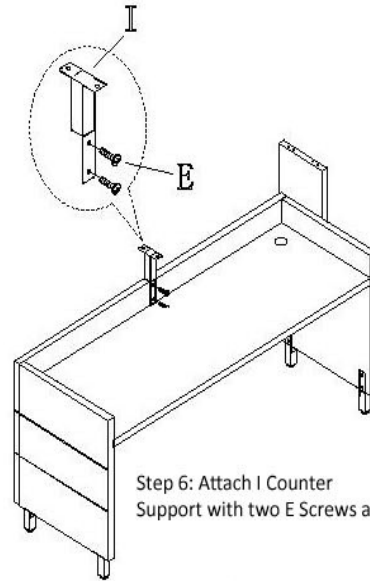

Step 6: Attach I Counter Support with two E Screws as shown.

6

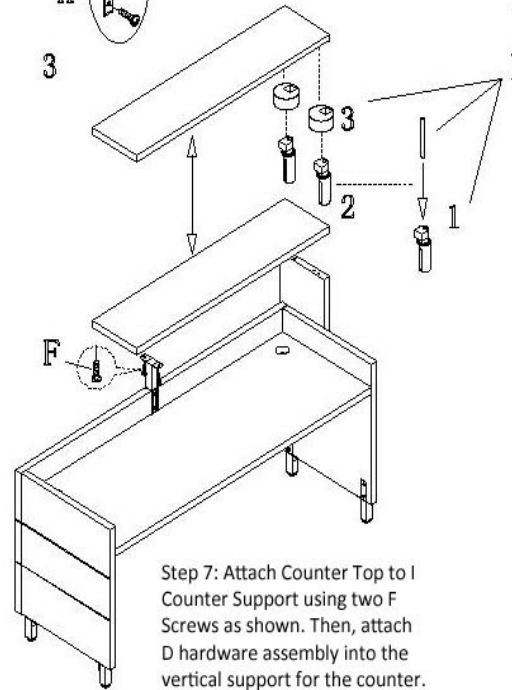

Step 7: Attach Counter Top to I Counter Support using two F Screws as shown. Then, attach D hardware assembly into the vertical support for the counter.

7

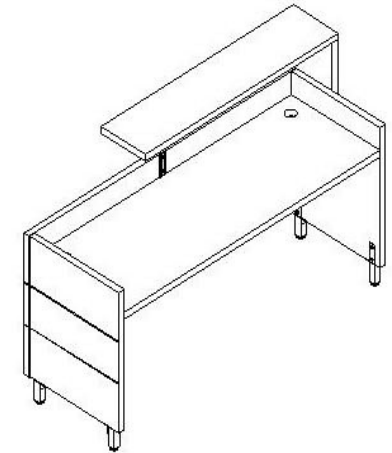

8

OZ-830

| | A | B | C | D | E | F | G | H | I | J | K | L | |
|--|-------|-------|-----------|-------|-----------|-----------|-----------|------|-----|------|-----|--------------|---------------|
| | | | M6x45 | | M6x20 | M6x16 | M6x30 | | | | | 235x25mm | 400x30x15 |
| | 14pcs | 14pcs | 6pcs | 2sets | 20pcs | 2pcs | 3pcs | 2pcs | 1pc | 4pcs | 1pc | 3pcs | |