



### Highlights

- *Constant Force (CF) patented lift-and-pivot motion technology produces smooth adjustment* 
- *Effortlessly adjust multiple monitors to the most ergonomically comfortable position*
- *Monitors move in tandem to maintain horizontal integrity*
- *Increase productivity and reduce errors*
- *Make efficient use of desk space*
- *Easy to use—simple installation and effortless operation*
- *5" (127 mm) height adjustability*
- *Integrated cable management*
- *Monitors can be installed portrait or landscape*
- *5 year warranty*

# Ergotron® LX

## Dual and Triple Display Lift Stands



### Raise and tilt your displays for maximum productivity

These cutting-edge solutions easily lift two or three displays on a single base while providing five inches of height adjustment. Simultaneously lift and tilt displays with just a touch of the hand for maximum ergonomic comfort. The LX Dual and Triple Display Lift Stands enable multiple documents to be viewed at one time ensuring the utmost productivity and accuracy in any work environment.

- Effortlessly adjust multiple monitors to the most ergonomically comfortable position
- Monitors move in unison to maintain horizontal integrity
- Multi-monitor solution will increase productivity and reduce errors
- Make efficient use of desk space
- Easy-to-use—simple installation and effortless operation



90° pivot for portrait or landscape viewing.

Cables are guided behind the stand for a clutter-free work area.

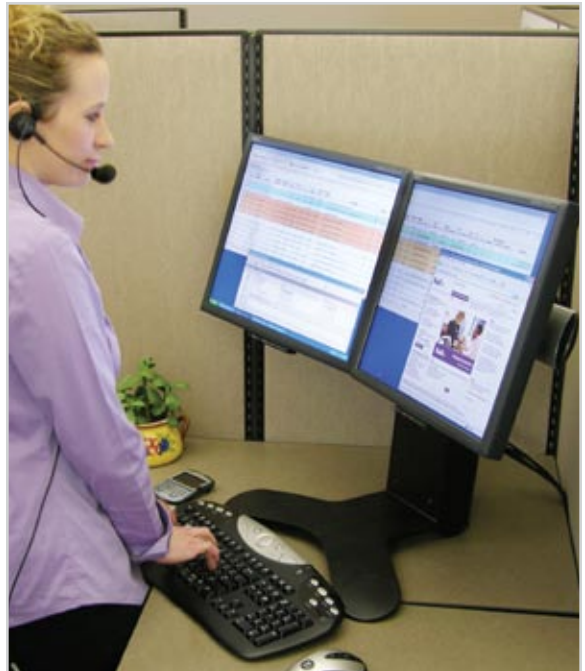

Why use a multi-screen configuration?

- 33% fewer errors are reported as a result of multi-screen configurations.
- 24% of workers feel more comfortable when using multiple monitors.

Source: NEC Display Solutions/University of Utah/ATI Technologies 2003 study, "Productivity and Multi-Screen Displays"

Lift and tilt your displays in tandem.

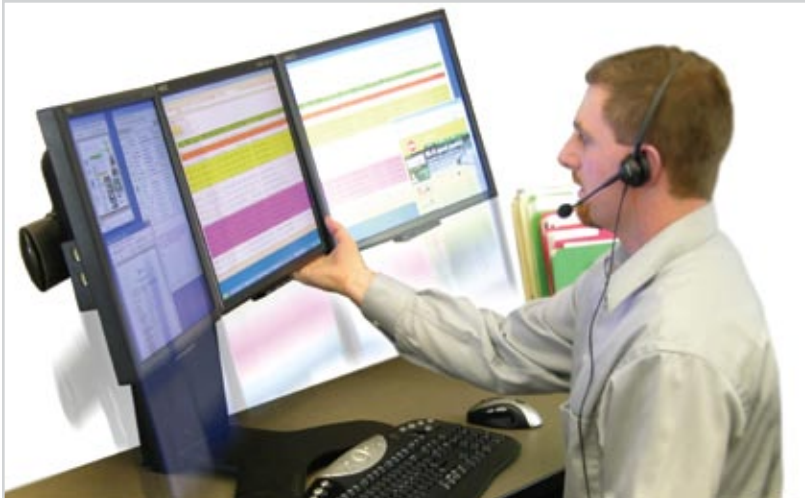

## Range of Motion

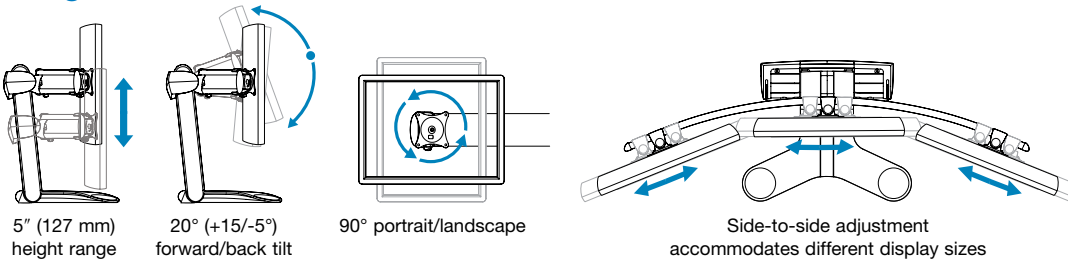

## Basic Specifications

**Display Interface Options:** VESA FDMI MIS-D, 100/75, C  
(hole pattern: 100 x 100 mm & 75 x 75 mm)

**Description:** LX Dual Display Lift Stand  
Commercial Part Number 33-299-195 (black)  
LX Triple Display Lift Stand  
Commercial Part Number 33-296-195 (black)

**Weight Capacity:** Dual 12–28 lbs (5.4–12.7 kg)  
Triple 18–48 lbs (8.1–21.8 kg)

**Maximum Display Size:** 22.9" (58.3 cm)

**Shipping Weight:** 33 lbs (15 kg)

**Warranty:** 5 year

© 2007 Ergotron, Inc. rev. 10/09/2007 870-05-065 Content is subject to change without notification

### Americas Sales and Corporate Headquarters

St. Paul, MN USA  
(800) 888-8458  
+1-651-681-7600  
www.ergotron.com  
sales@ergotron.com

### EMEA Sales

Amersfoort, The Netherlands  
+31 33 45 45 600  
www.ergotron.com  
info.eu@ergotron.com

### APAC Sales

Singapore  
www.ergotron.com  
info.apac@ergotron.com

### Worldwide OEM Sales

www.ergotron.com  
info.oem@ergotron.com

