

FA584200TX
KANTO PORTABLE
INDOOR/OUTDOOR GEL
FIREPLACE
Assembly Instruction

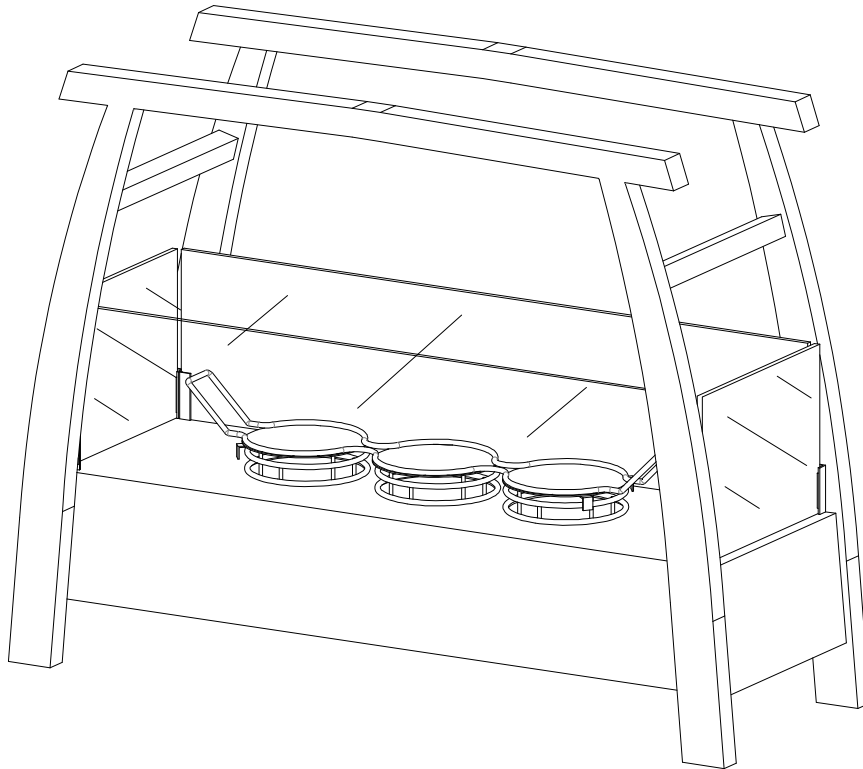

For assistance with assembly contact:
Southern Enterprises Inc.
Customer Service 1-800-633-5096
service@seidal.com
www.seidal.com

PO:



Patent Number D653739

© Southern Enterprises Inc. All Right Reserved.

FA584200TX

KANTO PORTABLE INDOOR/OUTDOOR GEL FIREPLACE

Assembly Instruction

Please review all parts and hardware before disposing of any packaging.
Call Customer Service if missing hardware. Do not return to store/retailer.
Using a screw that is too long will cause damage. Before beginning assembly,
separate each type of screw. Carefully study the screw diagrams below.
You may receive extra hardware with your unit.

(A) Fireplace frame

1 PC

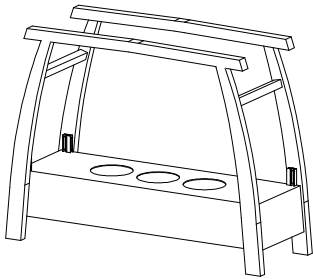

(B) Fuel canister holder

3 PCS

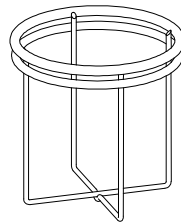

(C) Candle holder

1 PC

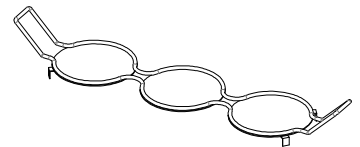

(D) Long glass panel

2 PCS

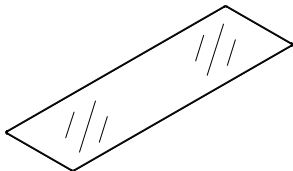

(E) Adhesive pad

8PCS



(F) Short glass panel

2PCS

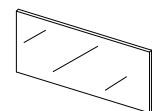

Care and Cleaning Instructions:

Before using, wipe with a clean, dry cloth.
Avoid rubbing or scratching the
surface with rough or abrasive objects.

For replacement parts or questions, please
call Customer Service at 1-800-633-5096.
Do not return product to store. Please call
manufacturer for assistance, questions or
parts.

FA584200TX

KANTO PORTABLE INDOOR/OUTDOOR GEL FIREPLACE

Assembly Instruction

⚠ DANGER

PLEASE USE IN WELL VENTILATED AREA

The fireplace will have open flames and will generate heat.

- Make sure to keep all combustible items away from the fireplace when the gel fuel is burning.
- DO NOT touch the fireplace when the gel fuel is burning.

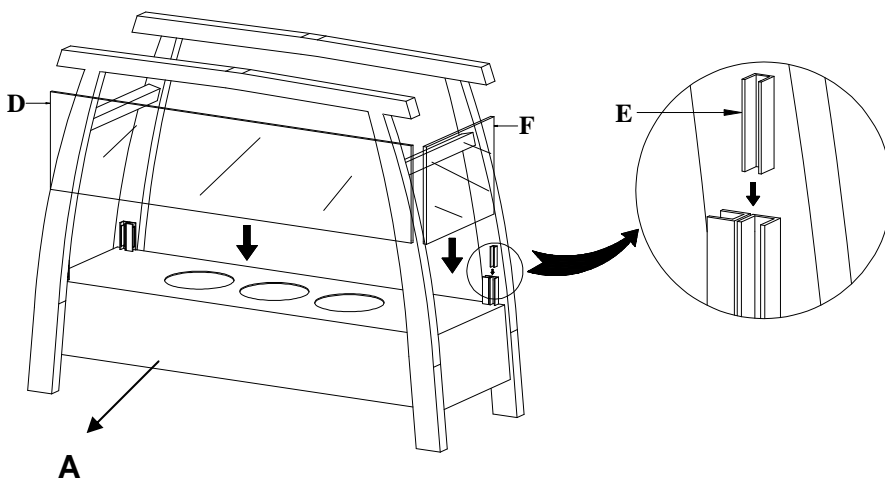

1. Put adhesive pad (E) onto the fireplace frame (A) as shown, then insert long glass panel (D) and short glass panel (F) into the holder as shown.

Figure 1 – Install Fireplace

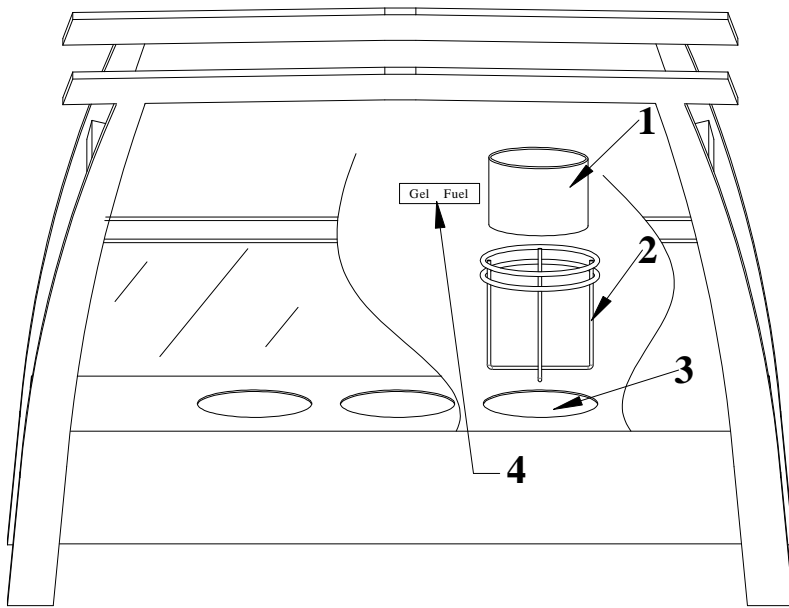

Figure 2 –Fuel Canister Holder and Gel Fuel Canister

2. Remove the fuel canister holders (2, Figure 2) from the fireplace and install one gel fuel canister (1, Figure 2) into each of the holders.

NOTICE

Make sure to remove the gel fuel canister paper label (4, Figure 2) before installing the canister into the holder.

Shake the gel fuel canister before installing it into the canister holder.

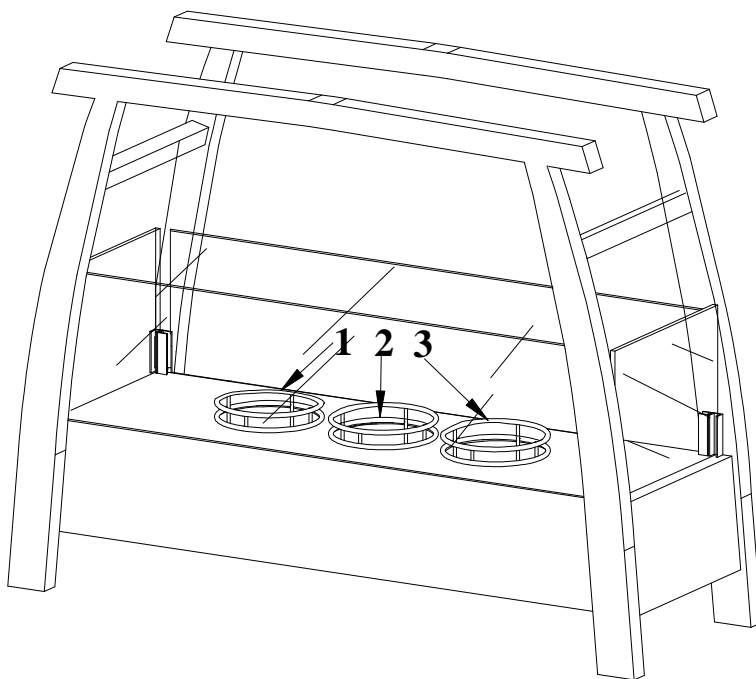

Figure 3 –Fuel Canister Installed

3. Install the gel fuel holders into the fireplace into the appropriate mounting hole (3, Figure 3) in the fireplace.

4. Following the instructions on the gel fuel canister, remove the lid (2, Figure 3) from the gel fuel canister (1, Figure 3), and using a long match, light the fuel in each of the canister. Candle holder can be used to extinguish fire.

⚠ DANGER

- **PROLONGED USE OF THE GEL FUEL IN THE FIREPLACE WILL CAUSE THE FIREPLACE TO BECOME HOT AND POTENTIALLY CAN CAUSE BURNS IF TOUCHED.**
- **DO NOT BURN MORE THAN THREE CANISTERS OF FUEL AT ONE TIME.**
- **BEFORE LIGHTING THE FUEL, MAKE SURE THAT THE PAPER LABEL IS REMOVED FROM EACH OF THE GEL FUEL CANISTERS.**
- **USE LONG MATCHES TO LIGHT EACH CANISTER OF FUEL.**
- **DO NOT TOUCH THE CANISTERS WITH BARE HANDS UNTIL THE FLAME HAS BEEN EXTINGUISHED FOR 20 MINUTES.**
- **DO NOT BURN ANYTHING EXCEPT THE SPECIFIED CANISTERS OF GEL FUEL IN THE FIREBOX.**
- **KEEP CHILDREN AWAY FROM THE FIREPLACE WHEN IN USE.**
- **KEEP FLAMABLE OBJECTS, SUCH AS CURTAINS OR DRAPERYS, AWAY FROM THE FIREPLACE WHEN THE GEL FUEL HAS BEEN IGNITED.**
- **MAKE SURE THE CUSTOMER DOES NOT PLACE ANY DECORATIVE ITEMS ON TOP OF THE UNIT AT ANYTIME.**
- **DO NOT TOUCH THE UPPER PART OF THE UNIT WHILE IT IS STILL IN OPERATION.**
- **THE CANDLE HOLDER ACTS AS A COVER TO PUT OUT FIRE IF ONE WISHES TO STOP THE FLAME.**
- **NEVER LEAVE BURNING GEL FUEL UNATTENDED.**
- **CARE INSTRUCTION: WIPE DOWN UNIT AND CANDLE HOLDER WITH SOFT DAMP CLOTH.**
- **WHEN USING THE CANDLE HOLDER PLEASE MAKE SURE THAT THE CANNISTER HOLDERS ARE IN PLACE.**

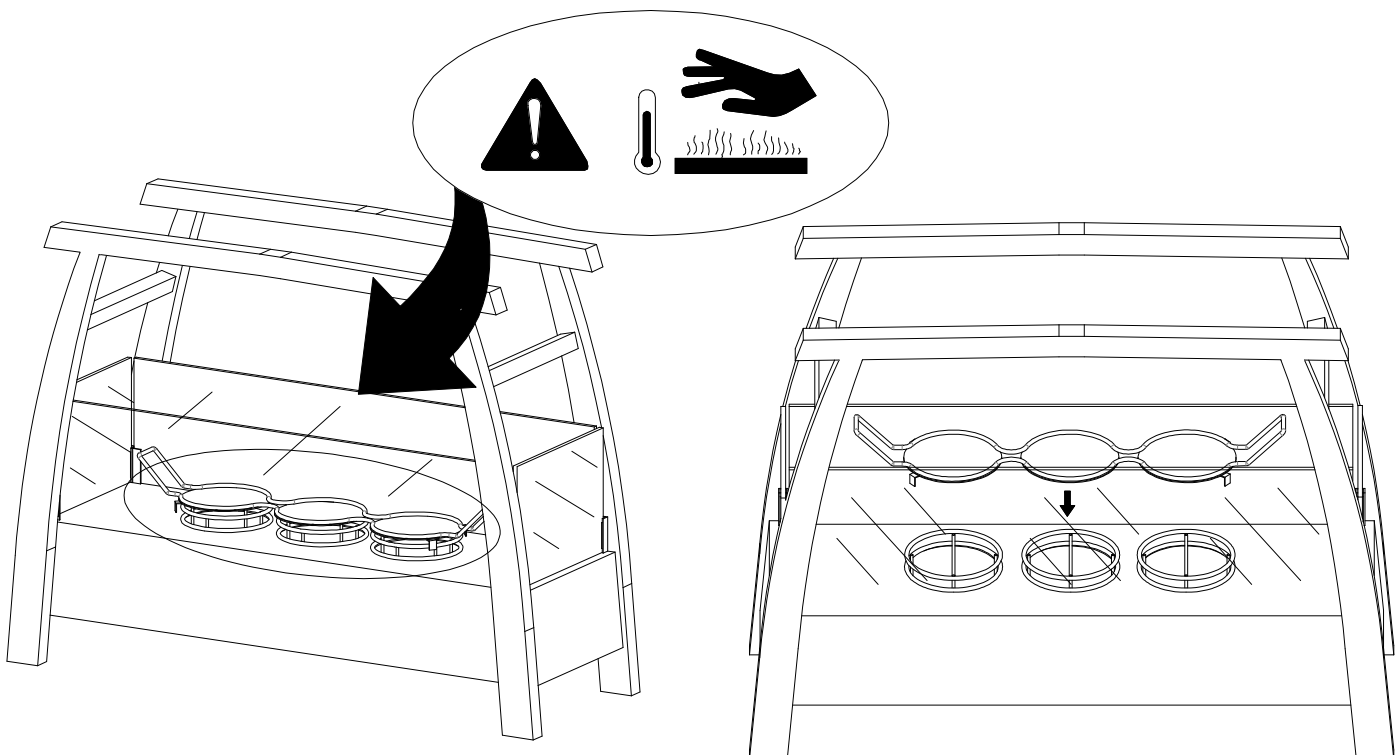

Parts Replacement Form

Customer Information

Name _____

Address _____

City/State/Zip Code _____

Phone Number _____

Please indicate where you purchased this item: Store/Website/Catalog

Please indicate color/size/style number:

Style No	Parts Letter	Parts Description	Quantity Needed
_____	_____	_____	_____
_____	_____	_____	_____
_____	_____	_____	_____

Please immediately examine this product carefully. Any request for missing parts or damage replacement must be received within 90 days of your receipt of the product. Replacement, if available, will be honored within this time frame. Parts will not be available for items arriving fully assembled. We do not recommend modifying product(s) and we are not responsible for any damages due to product modification(s). If damages or missing parts are not reported within 90 days of your receipt, we are under no obligation to provide parts or replacement merchandise.

Please contact Southern Enterprises at 800-633-5096 or in Dallas 972-869-0111/ 9am – 4pm Mon-Fri Central time if you have product issues or email us at service@seidal.com. Please ask for customer service representative for issues involving damages or replacement parts. Please ask for technical assistance representative for any issues with product and assembly/construction.

Please contact the retailer that you purchased from for returns.



Customer Service 1-800-633-5096
service@seidal.com
Southern Enterprises, Inc.
600 Freeport Parkway, Suite 200
Coppell, Texas 75019