

How to install the LG-2WP LineGrabber™ for wall phones, and to replace other existing phone jacks for a permanent installation.

LG-2WP Wall Plate LineGrabber™ IMPORTANT INSTRUCTIONS

1. Read and understand all instructions.
2. Follow all warnings and instructions marked on the product.
3. Do not use this product near water, for example, near a bath tub, wash bowl, kitchen sink, or a laundry tub, in a wet basement, or near a swimming pool.
4. Never push objects of any kind into this product through case openings as they may touch dangerous voltages.

SAVE THESE INSTRUCTIONS

Installation Instructions

- A) "Never Install telephone wiring during a lightning storm."
- B) "Never install this telephone jack in wet locations."
- C) "Never touch uninsulated telephone wires or terminals unless the telephone line has been disconnected at the network interface."
- D) "Use CAUTION when installing or modifying telephone lines."
- E) "Persons with Pacemakers should never work with telephone wiring."
- F) "Install this device top up in a single gang electrical box with screws provided."
- G) "When installing the LG-2WP to replace standard wall jacks, remove the 2 phone mounting pegs and secure the front cover plate with large head screws provided."

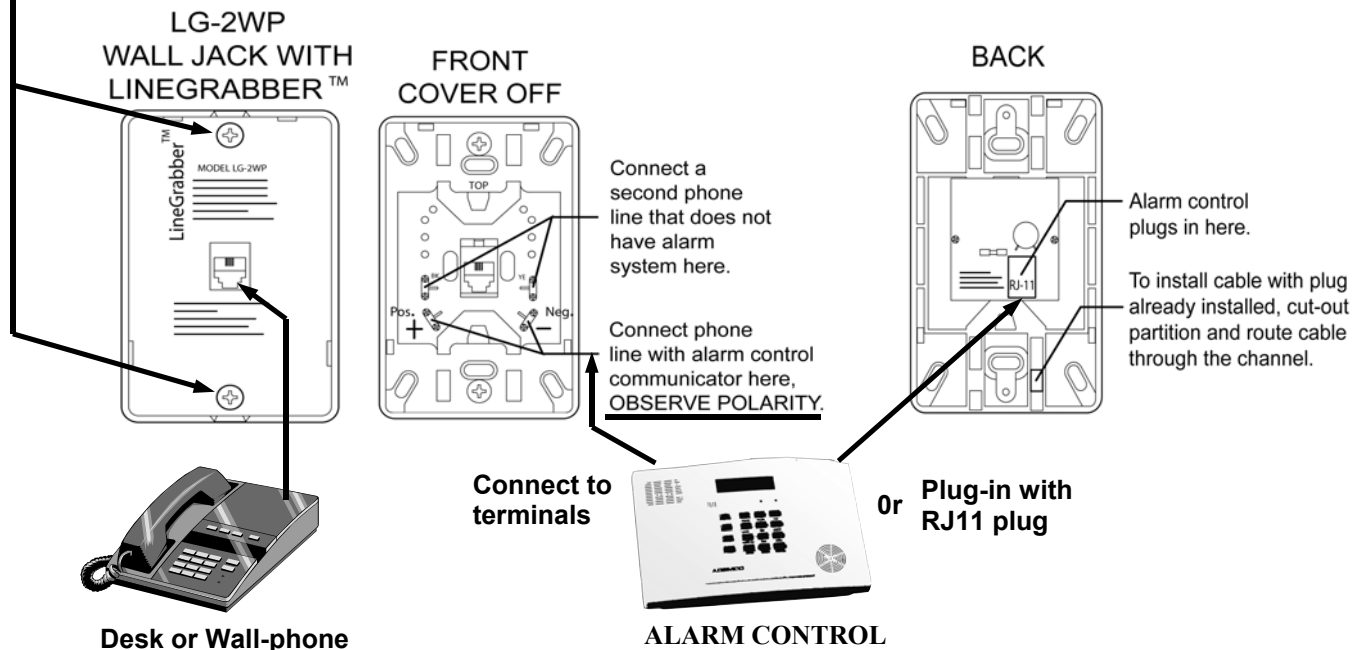

& A*N*D LLC
Alarm Network Devices LLC

1902 Midway Lane, #114
Bellingham, WA 98226
Telephone: 360-715-3755 Fax: 360-715-2802
E-Mail andllc@qwestoffice.net
www.linegrabber.com