

UNITED PERMANENT METAL UNDERCOUNTER RX UNITS

The metal undercounter RX units are a part of our unique product line, designed and manufactured by United.

All pharmacy under counter cabinet units are 24" long, 24" wide and 38" high. All units have levelers. Made from metal. Standard Finish: White color. Powder coated. Other colors are available by special request.



Closed Storage Unit

Description

The closed storage unit has an upper metal sliding drawer with dividers for storage. One lower sliding tray and storage door for maximum security.

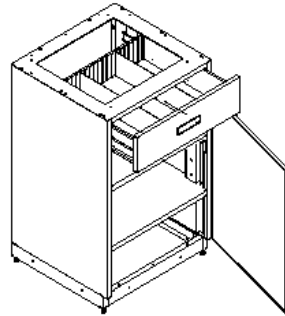

Item#	Color	Style
RXOS-W	White	Assembled
RXOS-W-KD	White	Knock-Down

Vial Unit

Description

The vial unit has two slanted shelves with sliding drawers. Opening above each drawer is about 10" so that bulk stored plastic vials can be accessed without pulling the drawer out. Each drawer includes four dividers.



Item#	Color	Style
RXVU-W	White	Assembled
RXVU-W-KD	White	Knock-Down

Bottle Dispenser Unit

Description

Bottle dispenser Unit features three self-feeding slanted shelf drawers which keeps bottle and supplies readily accessible. Each drawer includes five adjustable dividers.



Item#	Color	Style
RXBUDU-W	White	Assembled
RXBUDU-W-KD	White	Knock-Down

Narcotic Unit

Description

Narcotics Unit includes flat bottom drawer with locking storage. Along with 2 internal gliding trays with each have four dividers. Also for extra security a locking hinged door and locking drawer.



Item#	Color	Style
RXNU-W	White	Assembled
RXNU-W-KD	White	Knock-Down

UNITED PERMANENT METAL UNDERCOUNTER RX UNITS



The metal undercounter RX units are a part of our unique product line, designed and manufactured by United.

All pharmacy under counter cabinet units are 24" long , 24" wide and 38" high. All units have levelers. Made from metal. Standard Finish: White color. Powder coated. Any other colors are available by special request.

Prescription File Unit

Description

Prescription File Unit has five equal flat bottom drawers. Each drawer has 2 dividers and 3 compartments for prescription files. Heavy duty extension drawer glides supports paper loads



Item#	Color	Style
RXPFU-W	White	Assembled
RXPFU-W-KD	White	Knock-Down

Trash Unit

Description

Trash Unit has hinged door which hides trash receptacle. Trash receptacle not included

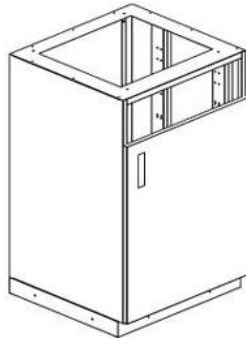

Item#	Color	Style
RXTU-W	White	Assembled
RXTU-W-KD	White	Knock-Down

Sink Unit

Description

Sink Unit includes hinged door along with panel to hide pipes and other hardware.

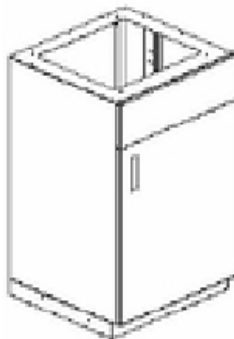

Item#	Color	Style
RXSU-W	White	Assembled
RXSU-W-KD	White	Knock-Down

UNITED PERMANENT METAL UNDERCOUNTER RX UNITS



The metal undercounter RX units are a part of our unique product line, designed and manufactured by United.

All pharmacy under counter cabinet units are 24" long , 24" wide and 38" high. All units have levelers. Made from metal. Standard Finish: White color. Powder coated. Any other colors are available by special request.

Computer Unit

Description

Computer Unit features a hinged perforated door for ventilation. Includes one internal gliding shelf.

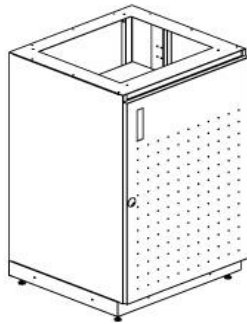

Item#	Color	Style
RXCU-W	White	Assembled
RXCU-W-KD	White	Knock-Down

Printer Unit

Description

Printer Unit comes with heavy duty drawer, glides to support the weight of the printer on a pull-out shelf.

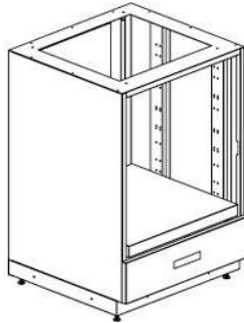

Item#	Color	Style
RXPU-W	White	Assembled
RXPU-W-KD	White	Knock-Down

Open Storage Unit

Description

Open storage Unit includes two steel adjustable shelves.

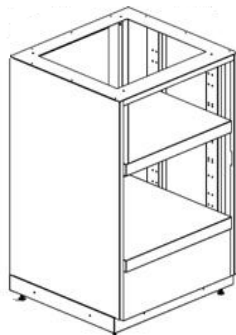

Item#	Color	Style
RXOSU-W	White	Assembled
RXOSU-W-KD	White	Knock-Down