



Visit our website: www.nsi-int.com

Ages 5 and Up

Conforms to ASTM D-4236
No. 23048-08

Create-A-Color™ Nail Salon

WARNING:
CHOKING HAZARD-Small parts.
Not for children under 3 years.

Dear Customer,

We hope you enjoy your Create-A-Color™ Nail Salon. If you find that we have made an error or if something is missing or damaged, let us know so that we can correct the problem for you. Please include the following information:

- Name of item
- Date of Purchase
- Purchase Price (please include sales slip)
- Model number
- Place of Purchase
- Brief description of the problem

Do not return the kit to the store where you purchased it, they will not have the replacement parts.

Send all correspondence to: **NSI International, Inc.**

**105 Price Parkway
Farmingdale, NY 11735-1318
Attn: Quality Control Department
Telephone: (631) 501-7550 • email: custserv@nsi-int.com**

Read instructions completely before starting your project.

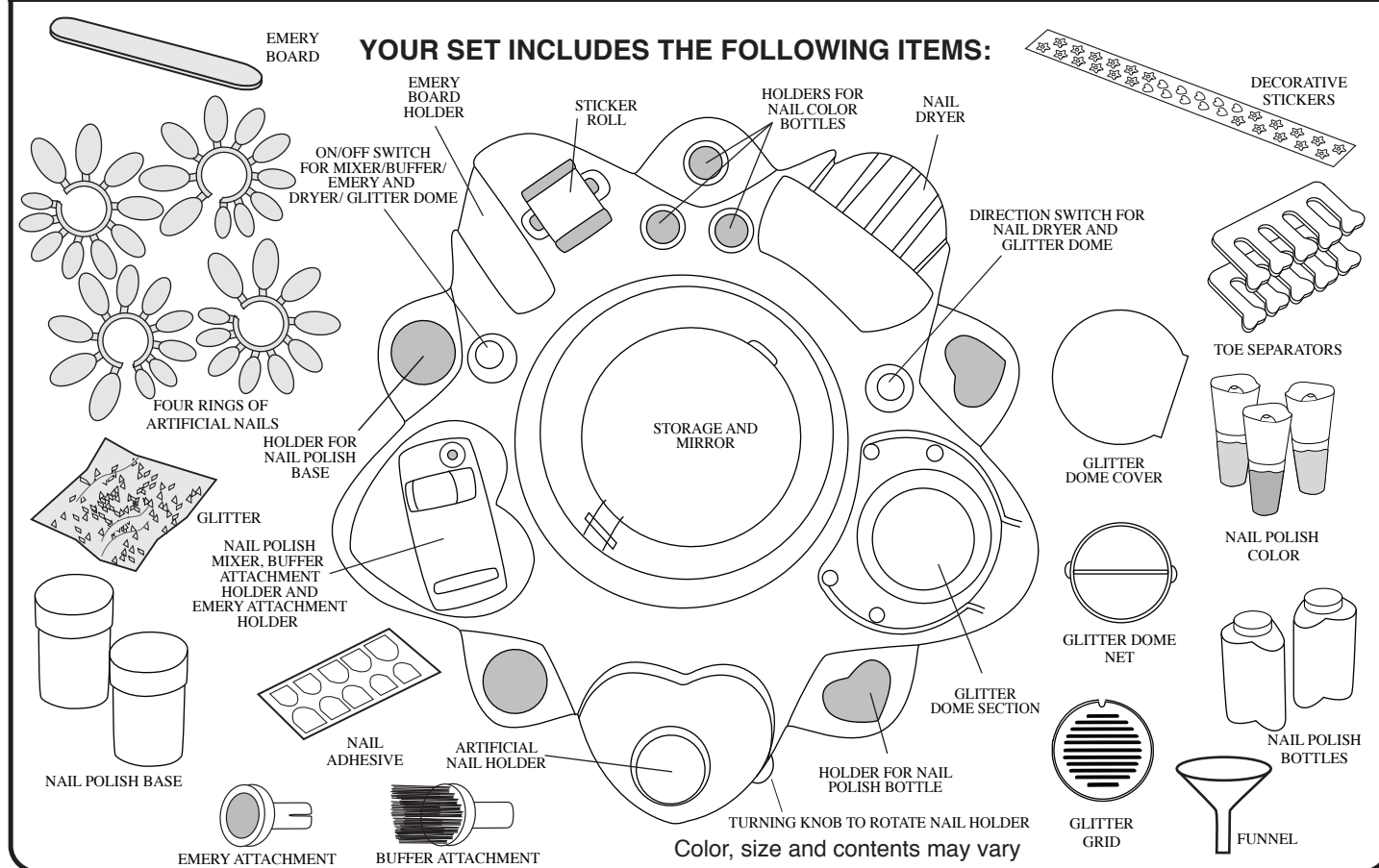

You should organize your supplies away from carpeting and upholstery on a suitable working area such as a kitchen table with a sink nearby. The polishes in this set are very high quality and non-toxic and may permanently stain fabrics, clothing, furniture, and carpeting. Do not work with polishes over carpeting or upholstery. Always wear a smock when working. If any polish gets on fabric, rinse immediately with water.

IMPORTANT BATTERY INFORMATION:

- Non-rechargeable batteries are not to be recharged.
- Rechargeable batteries are to be removed from the toy before being recharged.
- Rechargeable batteries are only to be charged under adult supervision.
- Different types of batteries or new and used batteries are not to be mixed.
- Only batteries of the same or equivalent type as recommended are to be used.
- Batteries are to be inserted with the correct polarity.
- Exhausted batteries are to be removed from the toy.
- The supply terminals are not to be short circuited.
- Keep packaging for reference since it contains important information.

HOW TO INSTALL BATTERIES IN THE NAIL SALON

Have an adult help with this.

1. Turn the Nail Salon upside down
2. Use a Phillips head screwdriver to loosen the screw holding the battery cover in place.
3. Insert 2 "AA/LR6" size alkaline batteries in the battery compartment, carefully noting the direction of the (+) and (-) symbols on the batteries.
4. Replace the battery cover and tighten the screw in place.

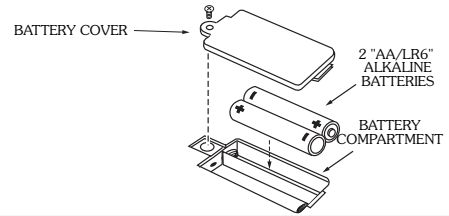

HOW TO ATTACH THE MIRROR AND STORAGE UNIT

1. Locate your mirror and storage unit.
2. Fit the piece into the grooves on your base nail station, as shown.
3. Open the top lid to access your mirror and storage section.
4. Peel plastic film from the mirror.

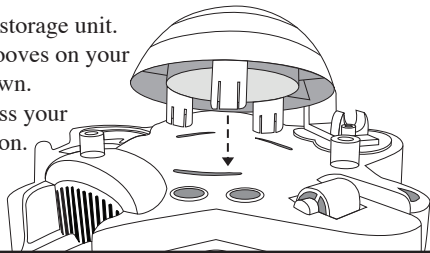

HOW TO TAKE APART AND REASSEMBLE THE GLITTER DOME

1. Locate your clear glitter dome and pop it off the unit.
2. Remove the grid and glitter net assembly to collect excess glitter from the machine.
3. To reassemble, place your grid and net assembly back into the open "Glitter Dome Section".
4. Snap the clear glitter dome back into place.

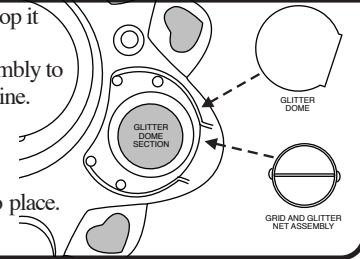

HOW THE NAIL SALON OPERATES

The two knobs located on top of the Nail Salon control two different functions:

1. The knob next to the glitter dome selects the direction of air flow.
 - a. Turn this knob clockwise to direct the air flow to the glitter dome.
 - b. Turn this knob counter-clockwise to direct air flow to the nail dryer.
2. The knob next to the emery board holder controls the nail salon functions.
 - a. Turn this knob to position 1 to activate the nail polish mixer/buffer.
 - b. Turn the knob to position 0 to shut off.
 - c. Turn this knob to position 2 to activate the glitter dome or the nail dryer.

Turn switch to position 1 to activate the mixer/buffer
Switch to position 0 for off
Switch to position 2 to activate the glitter dome/nail dryer.

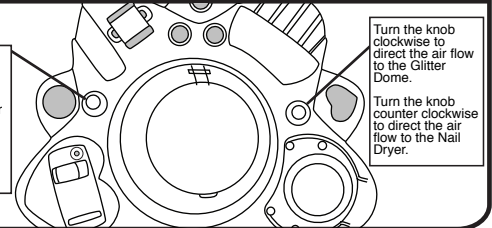

HOW TO MAKE DIFFERENT COLORED NAIL POLISH

1. Locate the bottle of nail polish base, the nail polish bottles, brushes, the funnel, and the three bottles of colored nail polish.
2. Remove the cap from the bottle of clear nail polish base.

HOW TO BLEND DIFFERENT COLORS

1. Put funnel into the opening of nail polish bottle. Pour clear nail polish through the funnel into a nail polish bottle until it is $\frac{1}{2}$ full.
2. Add a few drops of colored polish into the nail polish bottle through the funnel. You can use one color or mix colors. Your bottle should be $\frac{3}{4}$ full when you are finished.

Color Mixing Guide:
Red + Yellow = Orange
Blue + Red = Purple
Blue + Yellow = Green



Note: The more clear polish you use, the lighter your color will be.

For GREEN & TURQUOISE BLUE Nail Color:

Using the BLUE & YELLOW Nail Color:

- 4 drops of YELLOW plus 1 drop of BLUE = Transparent Lime Green
- 4 drops of YELLOW plus 2 drops of BLUE = Transparent Emerald Green

For VIOLET Nail Color:

Using the RED & BLUE Nail Color:

- 3 drops of RED plus 1 drop of BLUE = Very Pale Transparent Lavender
- 6 drops of RED plus 1 drop of BLUE = Purple Violet (Plum)

For PEACH Nail Color:

Using the YELLOW & RED Nail Color:

- 5 drops of YELLOW plus 2 drops of RED = Very Pale Peach
- 6 drops of YELLOW plus 3 drops of RED = Peach

For RED Nail Color:

Using the RED & YELLOW Nail Color:

- 8 drops of RED plus 1 drop of YELLOW = Light Transparent Pinkish Red
- 8 drops of RED plus 3 drops YELLOW = Rosy Red

For PURPLE Nail Color:

Using the BLUE & RED Nail Color:

- 3 drops of BLUE plus 1 drop of RED = Transparent Medium Royal Blue
- 3 drops of BLUE plus 2 drops of RED = Transparent Blue Violet

For PINK Nail Color:

Using the RED Nail Color:

- 5 drops of RED = Very Light Transparent Pink
- 7 drops of RED = Transparent Hot Pink

HOW TO MIX COLORS

1. Replace the nail polish bottle cap onto the bottle and make sure it is screwed on tightly.
2. Place the bottle into the nail polish mixer and snap in place until secure.
3. Turn the knob on the Nail Salon next to the emery board holder to position 1, to activate the mixer. The nail polish mixer will shake and blend the polish. Leave on for approximately 30 seconds and remove the bottle.

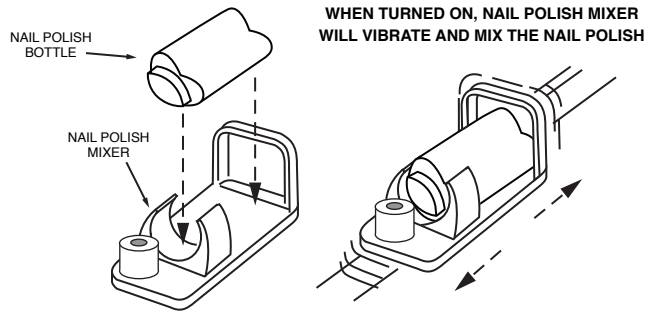

HOW TO ATTACH THE NAIL STICKER SHEET

1. Locate the sticker wheel and attach one end of the sticker sheet to it with a small piece of clear tape (not included).
2. Snap the wheel in place on the Nail Salon, as shown.
3. Rotate the wheel clockwise until the sticker sheet is wrapped around it.
4. Make sure the end of the sticker sheet sticks out.

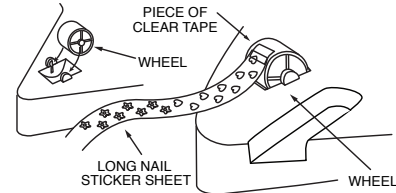

HOW TO DECORATE STICK ON NAILS

1. Locate your stick on nails and fit them over the round section of the heart shaped nail holder.
2. Rotate your nail decorator using the knob on the side. When you turn the knob clockwise, the nail holder turns counter-clockwise.
3. Attach stickers to your artificial nails.
4. Separate all nails from the ring and file down edges using the emery board.

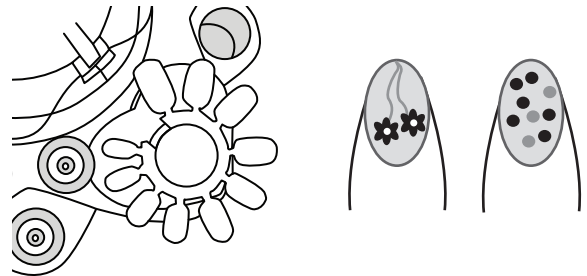

Note: Nails come in four beautiful colors, so there is no need for polish.

HOW TO ATTACH STICK ON NAILS

Before you begin, wash your fingers thoroughly with mild soap and warm water.

1. Locate the nail adhesive sheet and plastic nails.
2. Pick out plastic nails that fit your fingers.
3. Pick out an adhesive that fits your finger.
4. Peel off one adhesive and attach to your nail, sticky side down.
5. Peel off the backing on the adhesive.
6. Place a nail on top of the adhesive and press until it attaches firmly to your nail.
7. Repeat for all your fingers.
8. Use the emery board to file down edges.

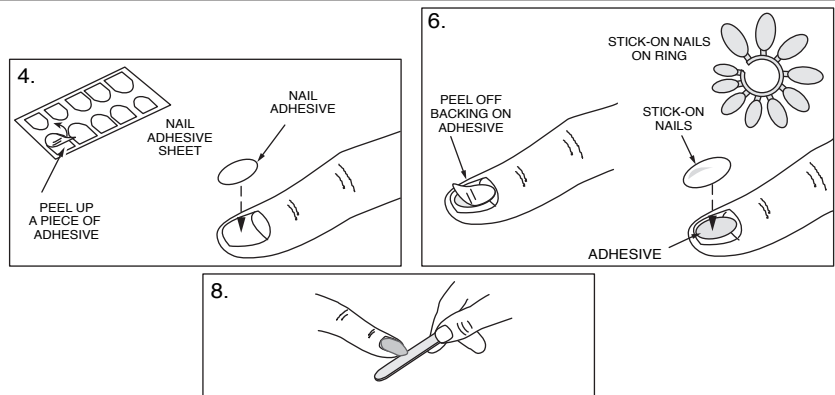

WARNING: PLASTIC NAILS SHOULD NOT BE WORN FOR MORE THAN 12 HOURS. Remove all nails and adhesives before bedtime. To remove plastic nails, soak fingers in warm water for a few minutes and carefully take off nails. Do not remove when dry. Wash hands thoroughly after removing plastic nails.

HOW TO USE NAIL BUFFER & EMERY ATTACHMENTS

1. The nail buffer and emery attaches to the shaker mechanism.
2. Attach the buffer or emery to the peg on the shaker mechanism.
3. Put your finger with nail surface next to the buffer or emery.
4. Turn the switch next to the emery board holder to position 1 to activate the buffer or emery.
5. Turn off switch when done by moving it into position 0.

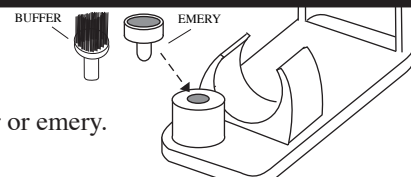

HOW TO APPLY NAIL POLISH TO REAL NAILS

1. Apply a light, even coat of polish to each nail with the brush.
2. After the first coat of polish has dried, apply a second coat.

HOW TO APPLY GLITTER TO REAL NAILS

Nail polish should still be moist before applying glitter

1. Locate the bag of glitter and the glitter dome.
2. Pour a small amount of glitter into the glitter dome.
3. Place finger inside the glitter dome.
4. To turn on the glitter dome, turn the switch next to the glitter dome clockwise.
5. Turn the switch next to the emery board holder to position 2 to activate the glitter dome.

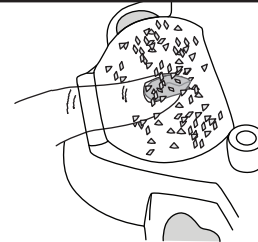

HOW TO DRY THE NAIL POLISH

1. Locate the area on the Nail Salon that has the vents for the Nail Dryer.
2. Place your fingers on the platform and turn the switch next to the glitterdome counter-clockwise to the nail dryer mode.
3. Turn the switch next to the emery board holder to position 2 to activate the nail dryer.
4. Dry your nails.

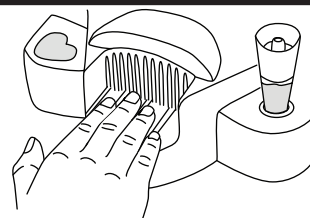

POLISH YOUR TOENAILS

1. Locate the toe separator.
2. Place the toe separator in between your toes, flat side down.
3. Polish your toenails.

TOE
SEPARATOR
(flat side down)

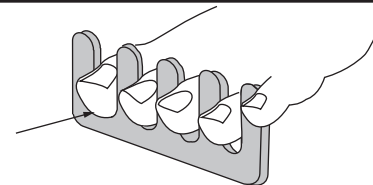

CARE AND CLEANING

1. The plastic nails should not be worn for more than 12 hours. Remove all nails and adhesives before bedtime.
2. To remove plastic nails, soak fingers in warm water for a few minutes and carefully take off nails. Do not remove when dry.
3. Wash hands thoroughly after removing plastic nails.
4. You can easily remove the polish from your real nails by washing with mild soap and water.
5. Do not use nail polish remover.

Helpful Hints

1. Always work on paper to protect your surfaces.
2. Before you mix new nail polish colors, be sure to wash everything with mild soap and water.
3. Bottles should be 3/4 filled for proper mixing.
4. Consult physician if irritation occurs.
5. Keep polish away from eyes.
6. Battery installation or replacement should be made by an adult.
7. Use only batteries recommended and be sure to insert them in the Nail Salon correctly.
8. Do not mix old and new batteries.
9. Do not mix alkaline, standard (carbon-zinc) or rechargeable (nickel-cadmium) batteries.
10. Do not attempt to burn batteries.
11. Dispose of batteries safely and correctly.
12. Be sure to remove batteries if your Nail Salon will not be used for a long period of time.

The clear base contains cosmetic grade ingredients of water, binders, surfactant and preservatives.
The colors contain cosmetic grade ingredients of water, colorants and a preservative.