

Contents



Beginner Projects	6
Textured Earrings	8
Charm Set	12
Jeweled Clasp	16
Wire-wrapped Cabochon Pendant	20
Floral Cone Trio	24
Riveted Bead	28
Three-strand Garden Bracelet	32
Bezel-set Gem Pendant	36
Inspiration Gallery	40

Intermediate Projects	48
Garden Ring Trio	50
Porcelain Fairy Pendant	54
Twisted Lariat Ring	58
Mermaid's Necklace	62
Beaded Leaf Brooch	66
Starburst Pendant	70
Silver-spiraled Glass Beads	74
Calla Lily Suite	78
Hollow Donut Bead	82
Sea Treasure Necklace	86
Inspiration Gallery	90
Materials and Tools	100
Resources About the Author	111



Three-strand Garden Bracelet

More ideas p. 46

Some metal clay jewelry components stand alone, while others work seamlessly together to create a beautiful finished piece of jewelry. Here, toothpicks and metal clay slip are used to make channels on the back of individual bracelet links, turning them into three-strand components.

I like to use organic elements in my designs, so tiny leaves embellish these components. The leaves are simple and fun to make, and the pinched ends of each leaf offer beginners a bit of hands-on metal clay work.

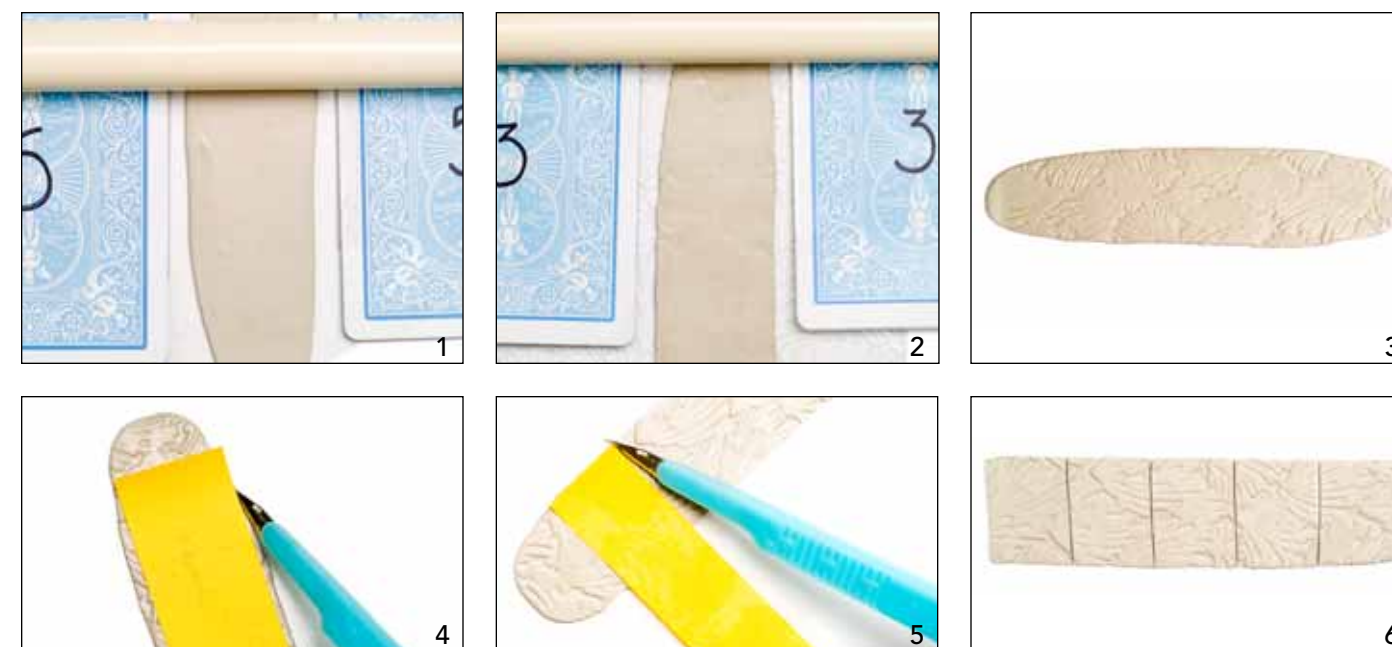

Make the bracelet links

Cut two strips of paper: one for the bracelet length, the other for the link width. Keep in mind that the clay will shrink by approximately 10% during firing. If the strip of paper determining the length is 20mm pre-firing, the fired piece will measure 18mm. My finished bracelet includes five components, each measuring 15 x 20mm.

1-3 Shape the clay into a square with your fingers. Roll the clay out to the thickness of five cards, rolling it in one direction and elongating it **[1]**. Keep in mind the

dimensions of the components as you roll. Apply extra Badger Balm to one side of the rolled-out clay and place it on the texture sheet, oiled side down. Roll the clay out again to the thickness of three cards **[2]**. Carefully remove the imprinted piece of clay from the texture sheet and place the clay back on the plastic mat, imprinted side up **[3]**.

4-6 Using the paper strips for measurements, use an X-acto knife or scalpel to trim the clay lengthwise **[4]** and cut out individual components **[5]**. Let the pieces dry **[6]**.

7 Use your sanding pad or emery board to file the edges of each piece, making sure that the pieces stay relatively uniform in size.

8 With a pencil, mark three parallel lines on the back of each piece (the positioning of lines on each piece should be the same).

9 Cut toothpicks into segments equal in width to the clay components. Glue three toothpick segments to the back of each component, matching them to the pencil marks.

Beaded Leaf Brooch

More ideas p. 94

Leaves are a recurring motif in my designs, whether the piece focuses on traditional wirework or metal clay. In this piece, a leaf is imprinted directly onto metal clay, and then it is embellished with crystals and pearls. It also incorporates traditional wirework, with beads and wire woven through the leaf.



tip

If you live in a cold climate without access to fresh leaves during the winter, buy herbs from the grocery store. Try large mint or basil leaves.

Choose a leaf with a beautiful shape and well-defined veins. The spirea leaf I chose is long and elegantly shaped – well-suited for a brooch.

1 Roll the clay out to the thickness of four cards. Be sure to roll the clay out so that it will accommodate the leaf.

2-4 Place the leaf on the clay, vein side down **[2]**, and roll over to imprint it into the clay, making sure that your roller rests on the card stacks at all times. Carefully remove the leaf **[3]**, using tweezers if needed. Use an X-acto knife or scalpel to trim the excess clay around the leaf image **[4]**.