

MANUAL INFLATOR SYSTEM 840 SERIES REARM INSTRUCTIONS

Step 1: Unscrew used CO₂ cylinder in a counter-clockwise direction and immediately discard. Do not insert new cylinder at this time. To avoid confusion later in the rearming process, we suggest you throw away the old CO₂ cylinder now.

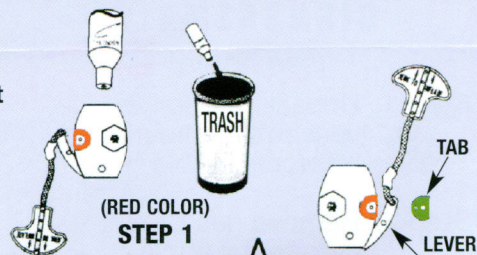

Step 2: Close manual inflator arm within inflator body and carefully insert a new green indicator tab so that it fully covers the red semi-circle on the body.

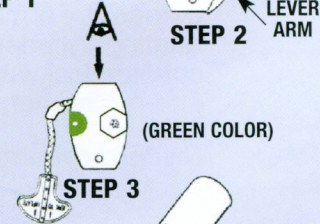

Step 3: Look into threaded cylinder receiver and view the gasket. If worn, replace with Halkey-Roberts 849AM gasket for 3/8" receiver or 849AML gasket for 1/2" receiver.

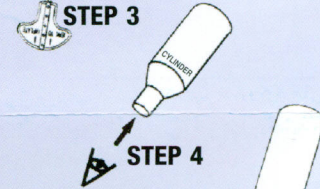

Step 4: Inspect the face of the new cylinder. Be sure it is smooth and has no holes or scratches. There is a gross weight on the cylinder. If you have any question about cylinder integrity, weigh the cylinder on a small scale, such as a postage scale. Compare the weight printed on the cylinder to the actual weight. If they do not match, get another cylinder.

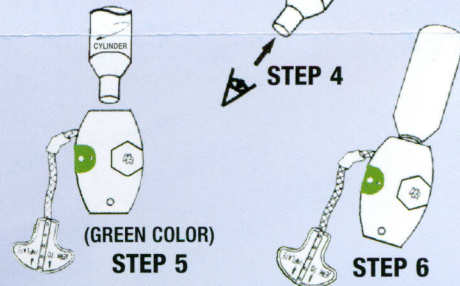

Step 5: Screw new cylinder in a clockwise direction firmly into the inflator. Do not over-tighten, but ensure the fit is tight.

Step 6: Check the inflator arming indicator every boating trip. It will tell you if there is a need for service. Check the cylinder face regularly to ensure it is not punctured.

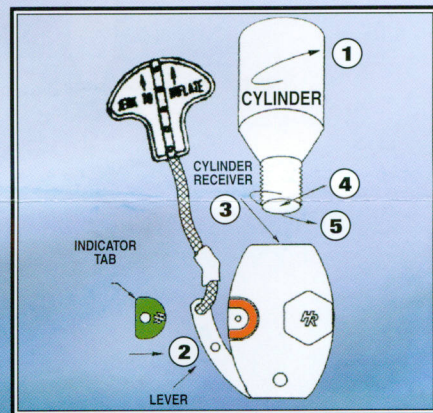

LELAND[®]
www.MaximumInflation.com