

VGSC gas 48" wide range – dimensions

Front

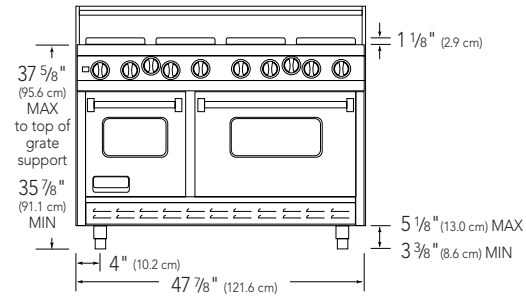

Rear

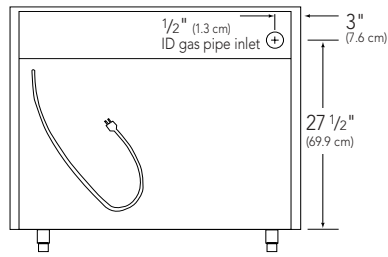

Side

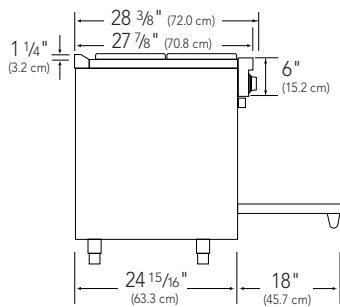

With island trim

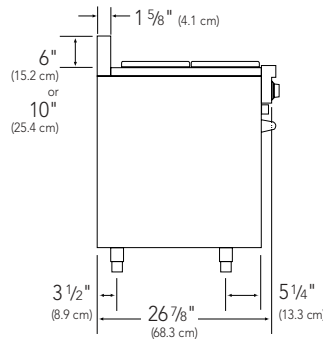

With backguard

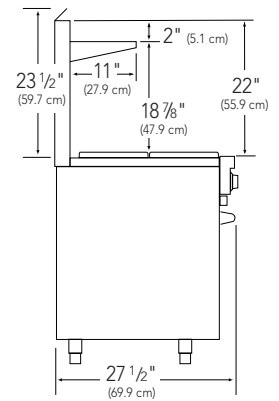

With high-shelf

Adjustable legs

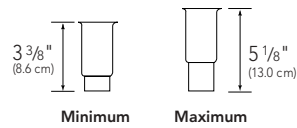

Surface burners

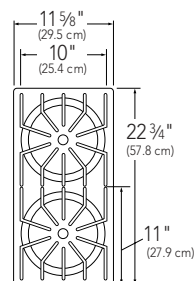

Grill

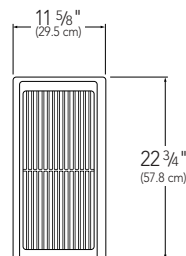

Griddle/simmer plates

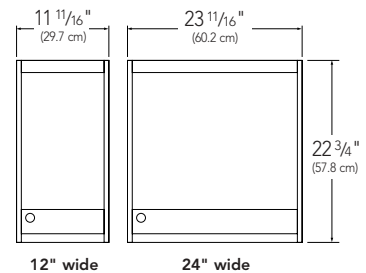

Notes

A properly grounded, adequately powered, horizontally mounted electrical receptacle should be installed no higher than 3" (7.6 cm) above the floor and not less than 6" (15.2 cm) from the right side (facing product). Check all local code requirements.

An agency-approved, properly sized manual shut-off valve should be installed no higher than 3" (7.6 cm) above the floor and not less than 6" (15.2 cm) from the left side (facing product). To connect gas between shut-off valve and regulator, use agency-approved, properly sized flexible conduit or rigid pipe. Check all local code requirements.

Basic specifications

Description	48" WIDE GAS RANGE
	VGSC486
Overall Width	47 7/8" (121.6 cm)
Overall Height from Bottom	<p>Base Height To top of grate support – min. 35 7/8" (91.1 cm) to max. 37 5/8" (95.6 cm); legs adjust 1 3/4" (4.5 cm)</p> <p>Additions to Base Height To top of spider grate – add 1 1/8" (2.9 cm), to top of island trim – add 1 1/4" (3.2 cm), to top of 6"H. backguard – add 6" (15.2 cm), to top of 10"H. backguard – add 10" (25.4 cm), to top of high-shelf – add 23 1/2" (59.7 cm)</p>
Overall Depth from Rear	To end of side panel – 24 15/16" (63.3 cm), to end of control panel – 26 7/8" (68.3 cm), to end of knobs – 28 3/8" (72.0 cm)
Gas Requirements	Shipped natural gas standard; field convert to LP/Propane with standard convertible regulator; accepts standard residential 1/2" (1.3 cm) ID gas service line
Electrical Requirements	120VAC/60Hz; 4 ft. (121.9 cm), 3-wire cord with grounded 3-prong plug attached to product
Maximum Amp Usage	6G – 6.4 amps 6Q – 2.4 amps 4G – 10.0 amps 4GQ – 6.4 amps
Surface Burner Rating	15,000 BTU NAT./13,500 BTU LP (4.4 kW NAT./4.0 kW LP)
Griddle Burner Rating	12" wide: 15,000 BTU NAT./13,500 BTU LP (4.4 kW NAT./4.0 kW LP) 24" wide: Two 15,000 BTU ea. NAT./Two 13,500 BTU LP (Two 4.4 kW ea. NAT./Two 4.0 kW ea. LP)
Grill Burner Rating	18,000 BTU NAT./16,000 BTU LP (5.3 kW NAT./4.7 kW LP)
Broil Burner Rating	Infrared (Right Oven Only) 18,000 BTU NAT./16,000 BTU LP (5.3 kW NAT./4.7 kW LP)
Bake Burner Rating	Right Oven 30,000 BTU NAT./LP (9.8 kW NAT./LP) Left Oven 15,000 BTU NAT./LP (4.4 kW NAT./LP)
Oven Interior Dimensions	<p>Right Oven – Convection Bake/Broil Width – 23" (58.4 cm) Height – 16 1/8" (41.0 cm) Depth – 15 3/8" (39.1 cm) Overall Size – 3.3 cu. ft. Three racks, six rack positions</p> <p>Left Oven – Bake Width – 12 1/8" (30.7 cm) Height – 16 1/8" (41.0 cm) Depth – 17 1/4" (43.8 cm) Overall Size – 2.1 cu. ft. Two racks, six rack positions</p>
Approximate Shipping Weight	6G – 624 lb. (280.8 kg) 6Q – 620 lb. (279.0 kg) 4G – 629 lb. (283.1 kg) 4GQ – 629 lb. (283.1 kg)