

VizuaLogic's™ SeatBack Monitor Solution for Ford Expedition Models

Takes just 30 minutes to install!

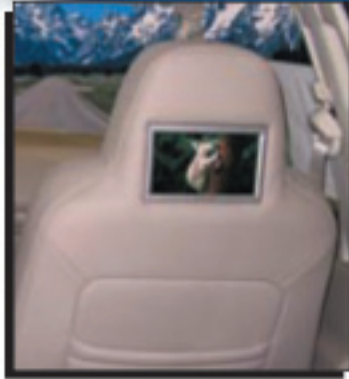

Basic Installation Steps:

1. Remove seat cover retainer clips at the bottom of the seat frame and pull off existing seatback cover and foam cushion.
2. Roll up seat cover and remove hog rings.
3. Remove cover from foam cushion and place Vizualogic pre-molded foam cushion onto seat frame.
4. Route the round connector up into the back of the seat foam and out of the plastic bucket. Install trim template into bucket.
5. Position seat cover on Vizualogic foam cushion.
6. Install hog rings.
7. Pull seat cover over entire foam cushion and re-secure seat cover clips to seat frame.
8. Cut around the inner edge template, remove the template and fold excess upholstery into bucket.
9. Connect the video cable.
10. Snap-in video screen. Connect monitor cable end to distribution module.

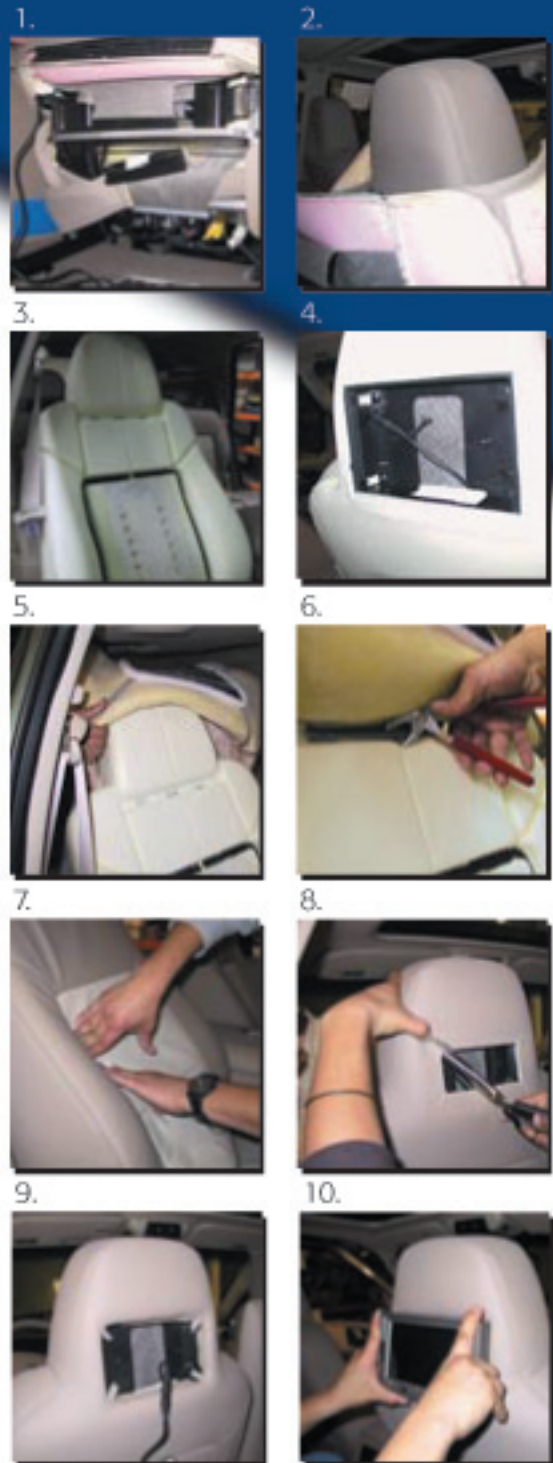

It's that simple!

VIZUA·L·OGIC