

## Mounting Instructions for Triton Products Storability Wall Storage Centers Model# 1760 (Rev-0509)

Inventory all components and please read these instructions thoroughly before starting installation.

Should you have questions or require installation help, please contact Triton Products directly at 440-248-5480 or 877-963-2990.

**Report damaged shipping cartons within 24 hours of delivery to shipping company**  
**Missing and Damaged parts must be reported within 5 business days from receipt of delivery.**

Components Listing					
P/N#	Qty=	Description	P/N#	Qty=	Description
10-01815T	2	Top Track Sections	10-2025	1 Set	Recycle/Storage Bag with Hang Bracket
10-0280-1T	3	Top Hang Rail with hanging Slots			
10-0280-2T	2	Bottom Hang Rail Section			
10-0280-3T	2	Hang Rail Connection Bracket with 2 bolts			<u>Hardware</u>
10-0480	1	31" wire Shelf			
10-0336	1 Set	Hanging Brackets for Wire Shelf	15		2-1/4" Long wood screw.
10-0540T	2	15" Combination Rail	15		White plastic Wall Anchors
10-0702	1	Curved Hook for Combination rail	10		Toggle Bolts 2-1/2" Long
10-0703	2	2" Single Rod Hook for Combination Rail	5		Toggle Bolts 3-1/2" long
10-0706	1	4" Double Hooks for combination Rail	15		Toggle Bolt Expanders
10-0708	1	C-Clamp Hook for Combination Rail	1		Hex head Tool for Hang Rail Connection
10-2018	3	Tool Keeper Hooks for Top Track			
10-1902T	2	15" Wire Basket			
10-2001	2 Sets	Hanging Brackets for Wire Basket			
10-20094T	1	15" Metal Shelf			
10-2030	1 Set	Hanging Brackets for Metal Shelf			

We have included all mounting hardware for hollow and concrete block wall installations. It is not necessary to mount system to wood studs. Each system will require 63.5 lineal Inches of wall space for mounting and a minimum ceiling height of 7-1/2 feet high for proper clearance.

**Drill Diameter Listing:**     **Drill diameter sizing for: Hollow wall Installations; Use 1/2" Standard Drill Bit**  
**Drill diameter sizing for: Concrete wall Installations; Use 5/16" Masonry Drill Bit**  
**Drill diameter sizing For: Wood Stud wall Installations; Use 1/16" Standard Drill Bit for pilot holes**

**Preparation for Top Track Installation: (Image A-1)**

1. If installing in a corner, leave 1" space between side wall and top track.
2. Determine the maximum height of storage you would like available above your system. (See Fig. A-1). For an 8 foot ceiling; 78" off the floor leaves 18" of storage above and 81" leaves 15" storage above.
3. Using a tape measure, mark your desired height off the floor with a 4" Long pencil mark.
4. (Refer to Fig. A-1 & A-2) Using a level, align top of top track with your pencil mark in step 3. With top track level, mark the center of each hole location on your wall. **(Note: Before starting to drill holes; always make sure all screw hole locations do not fall in line with electrical wires, Duct work or plumbing inside of your wall. If a potential problem exists, reposition and re-mark screw hole locations.)**
5. (Fig. A-2) Drill hole locations marked using the correct drill bit sizing and type listed above. Should you come in contact with wood studs, stop and mark the hole with X and after drilling all other holes come back and drill holes marked X using a 1/16" bit for pilot hole for wood screws.

**Attachment of Top Track to Wall Surface:** (Fig. A-3)

6. **For hollow walls;** (Fig. A-3) **Use 2-1/2" long toggle bolts with expanders. Make sure to insert all toggle bolts through top track and attach all toggle bolt expanders and insert toggle bolts with expanders into holes in wall before starting step 9.**
7. **For concrete walls;** **use white plastic wall anchors and 2-1/4" long wood screws. Install all plastic wall anchors in each pre-drilled hole location before starting step 9.**
8. **For wood studs;** **use 2-1/4" long wood screws. Always install wood screws last and there will be no need to use plastic wall anchors.**
9. Using a level and holding top track in place tighten one of the end bolts or wood screws until snug. (Allow for track movement).
10. Making sure top track is still level, tighten toggle bolt or install wood screw on opposite end until fully secure.
11. Install and fully tighten all remaining toggle bolts and wood screws.
12. **Second Top Track Installation:** (Refer to Figure A-4) and follow steps 4-11 above for your type of wall installation.

**Hang Rail Assembly:** (Fig. B-1)

13. Assemble (2) complete 63" long hang rail assembly consisting of 3 parts, (A) top rail section with hang slots. (B) Bottom rail section and (C) Hang rail connector with 2 bolts. Note: This kit also contains (1) Extra Top Hang rail section with hang slots that will be mounted by itself.
- Hanging Hang Rail:** (Fig. B-2 and B-3). **Note: When installing hang rails, always work from left to right or right to left. For this project you will be installing all 3 hang rail sections on the same top track section.**
14. (Fig B-2 and B-3) slip your three hang rails onto the front lip of 1 top track section with the two longest sections next to each other and the short section positioned at the opposite.

**Preparation for Hang Rail Installation:** (Fig. B-4) (Note: Completely install 1 hang rail section at a time starting with the longest sections.)

15. While keeping the top of the hang rail firmly against stop in top track and using a level to make sure hang rail is straight, mark the centers of both bolt holes locations in the bottom hang rail section onto your wall surface.
16. (Refer to Drill diameter listing above) Using the correct drill bit and diameter for your wall surface, drill out both holes locations marked in Step 15 using the correct drill bit for your type of wall surface. **(Note: Should you come in contact with internal wood studs; stop drilling and use a 1/16" bit to create pilot hole for wood screw installation.)**

**Attaching Hang Rail to Wall;** (Fig. B-3 through B-7) **Note: All 3 hang Rails should be on the same top track section.**

17. **For hollow walls use 3-1/2" long toggle bolts with expanders.** Insert both toggle bolts through bottom portion of hang rail and attached all toggle bolt expanders as shown in fig. B-7-and insert all toggle bolt with expanders into holes drilled in wall, before starting step 20.
18. **For concrete walls use white plastic wall anchors and 2-1/4" long wood screws.)** Install all plastic wall anchors in holes before starting step 20.
19. **For wood studs use 2-1/4" long wood screws. .**

20. While keeping straight tighten the top bolt first and then the bottom.  
**Second (Center) Long Hang Rail Attachment:** (Fig. B-4)
21. Slide second hang rail to the center of the Top track. Inside spacing should be 14.50" (14-1/2") between the two hang rail sections.
22. Using your (2) 15" long combination rail sections supplied with this system as a spacer, install 1 combination rail in the inside slot position of both rails; install 1 combination rail 6 slots from the top and the second combination rail 6 slots from the bottom.
23. Using a level make, sure second hang rail is straight and that you can easily removal both combinations rail sections. Mark the centers of both bolt holes locations in the bottom of your hang rail on your wall surface.
24. Drill out both hole locations marked ins step 23 using the appropriate drill size and type for your wall surface.
25. Complete installation by repeating steps 16-20 for your type of wall installation.  
**Third short hang rail attachment:** (Fig. B-4) (Note: You will be installing only the top slotted section that measure 31" long.)
26. Slide 3<sup>rd</sup> hang rail section onto the same top track section with the 2 other hang rail assemblies already installed. Slide hang rail until it comes in contact with inside edge of stop in top track.
27. To complete installation following steps 15-20 above.
28. **Accessory Installation:** *Always make sure you're installing all accessories level and into the identical height slots in both hang rails. Binding can occur if not level. All accessories will be installed in the inside slot positions of each hang rail. If accidental binding occurs use **soft rubber mallet** to help remove accessory and protect the paint.*
  - a. **Combination Rail:** (Note: Combination rails are capable of spanning hang rail sections if needed.) While level insert combination rail side mounting prongs into the inside row of notches in each hang rail and slide down into place.
  - b. **Combination Rail Hooks and Bins.** Loosen pressure screw in mounting plate of hook so that upper and lower back prongs can easily slip on to the 2 front mounting surfaces of combination rail. Once in position tighten pressure screw to prevent sliding. Slide hang bins back tab over top mounting surface of combination rail.
  - c. **Recycle-Storage bag with hanging bracket.** See Figure C-2 close-up showing insertion of top tabs into hang rails and hang bag using the 4 outside hanging loops with the pull zipper facing the back.
  - d. **Tool Keepers for Top Track:** Loosen pressure screw in top section of the tool Keeper, slide lip of tool keeper onto the front lip of top track, position in desired location and re-tighten pressure screw to prevent movement.
2. For all other accessories Refer to figures C-1 through C-5 for attachment of hanging brackets and installation.

**Safety Load limits on accessories should never exceed: 125 pounds for Wire and Steel shelves, 18 pounds on a single LocBoard hook, 150 pounds on combination rails sections or 35 pounds per combination rail hooks, 75 pounds per Top track hooks, 60 pounds for wire baskets and 75 pounds for recycle and storage sack.**

**Do not place sharp or pointed objects inside of recycle and storage bags. Rips or tears are not covered under warrantee.**

**Warrantee Information: All steel components are guaranteed free of defect for the life of the product. Rips, tears or punctures of recycle bag and storage sacks are not covered under warranty. Return defective parts only postage pre-paid along with copy of your original purchase receipt to:**

**Triton Products  
30700-D Carter Street  
Solon, Ohio 44139  
Phone 44-248-5480**

**Liability:** Triton Products and or it Resellers liability is limited to 100% of the purchase price of the product.

Visit [www.tritonproducts.com](http://www.tritonproducts.com) to view other great products.

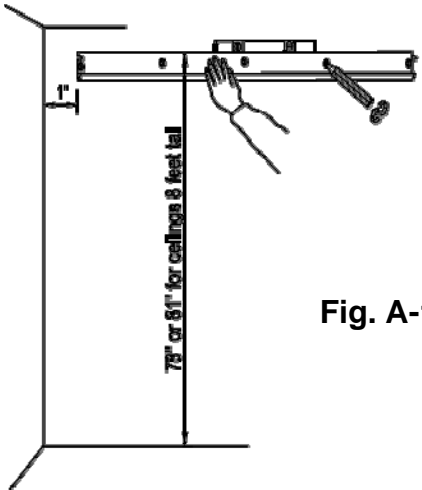

Fig. A-1



Fig. A-2

Drill Diameter  
 Hollow Wall: 1/2"  
 Concrete Block : 5/16"

- A: Toggle Bolt Expander
- B: 2 1/2" Toggle Bolt
- C: 3 1/2" Toggle Bolt
- D: Plastic Wall Anchor
- E: 2 1/4" Wood Screw

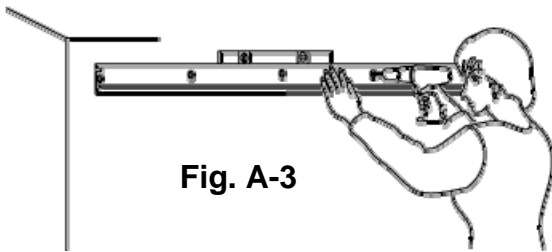
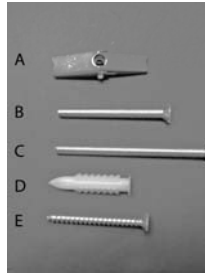

Fig. A-3

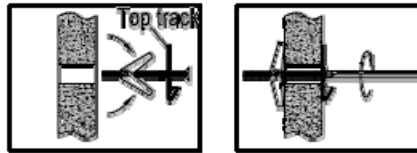

Fig. B-1

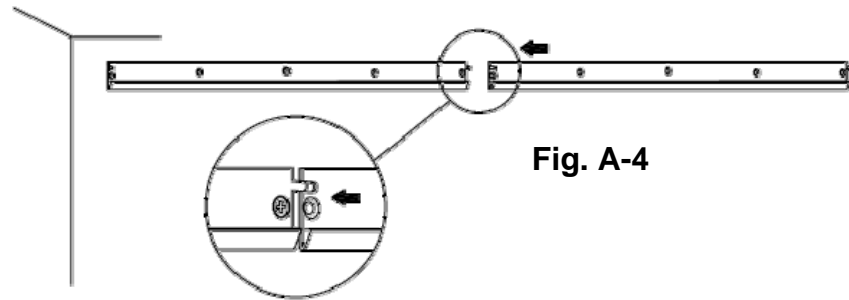

Fig. A-4

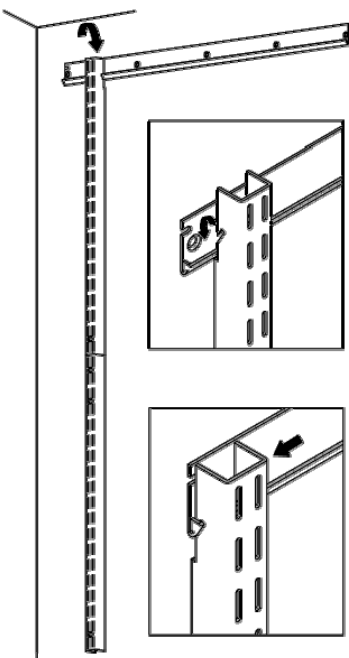

Fig. B-2

Fig. B-3

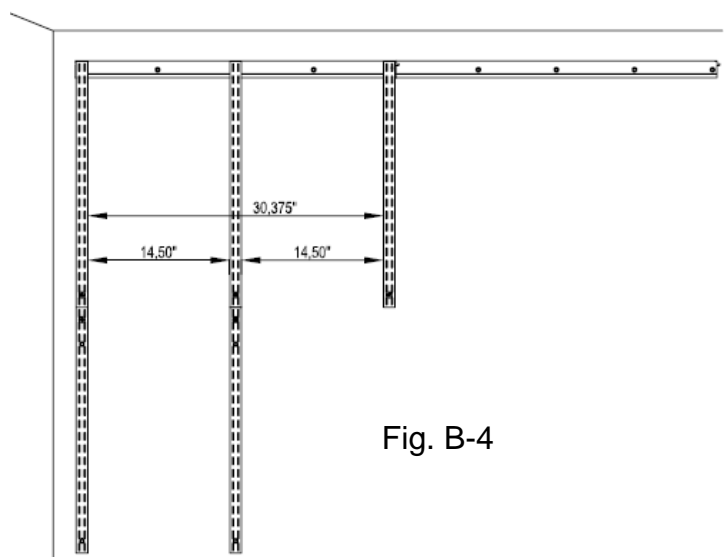

Fig. B-4

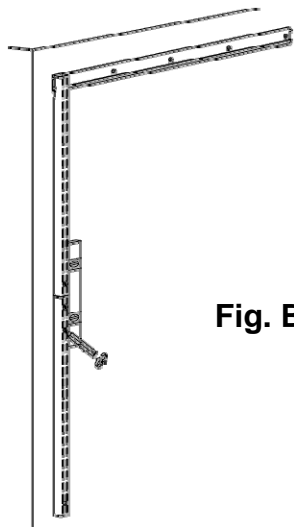

Fig. B-5



Drill Diameter  
Hollow Wall: 1/2"  
Concrete Block : 5/16"

Fig. B-6

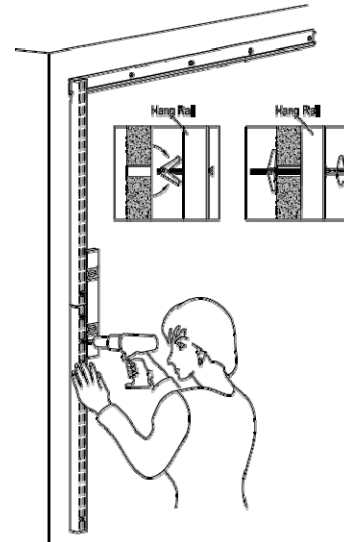

Fig. B-7

Fig. C-1 Wire Shelf Bracket installation and hanging installation

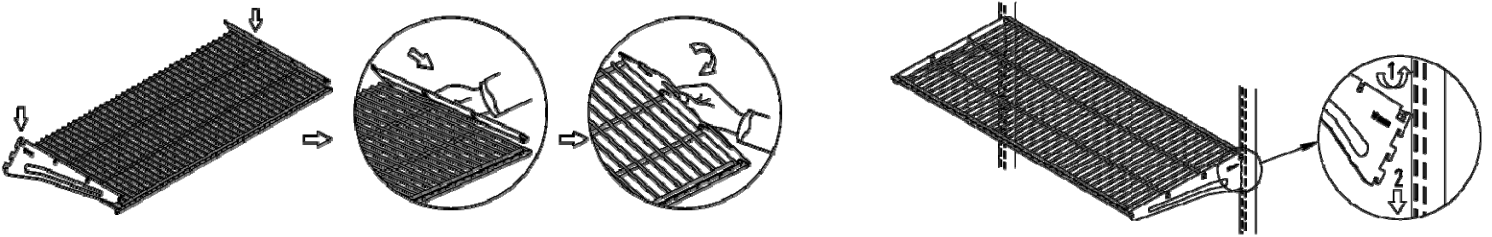

Fig. C-2 Wire Basket Bracket installation and hanging installation

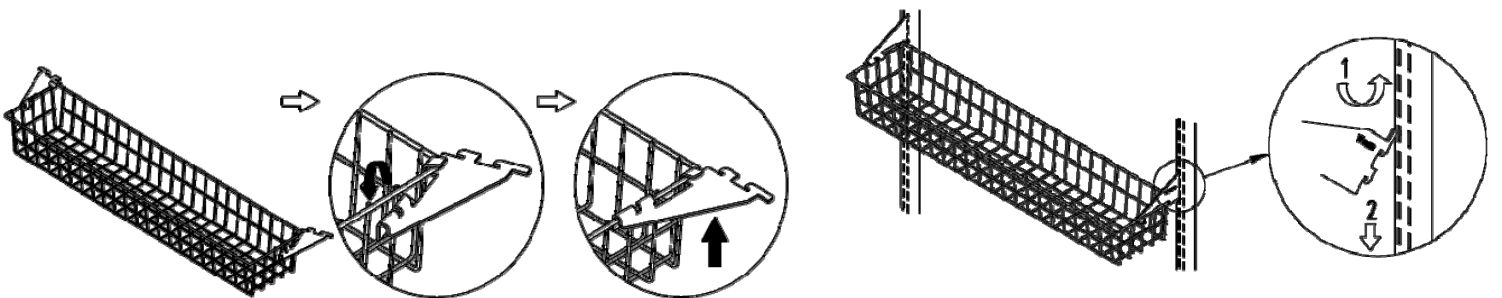

Fig. C-3 Metal Shelf Bracket installation and hanging installation



Fig. C-4  
LocHook  
Installation

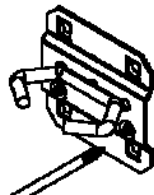

Fig. C-5  
Combination  
Rail Hook  
Installation

