

Strap Thang will accommodate a maximum 2 surfboards.

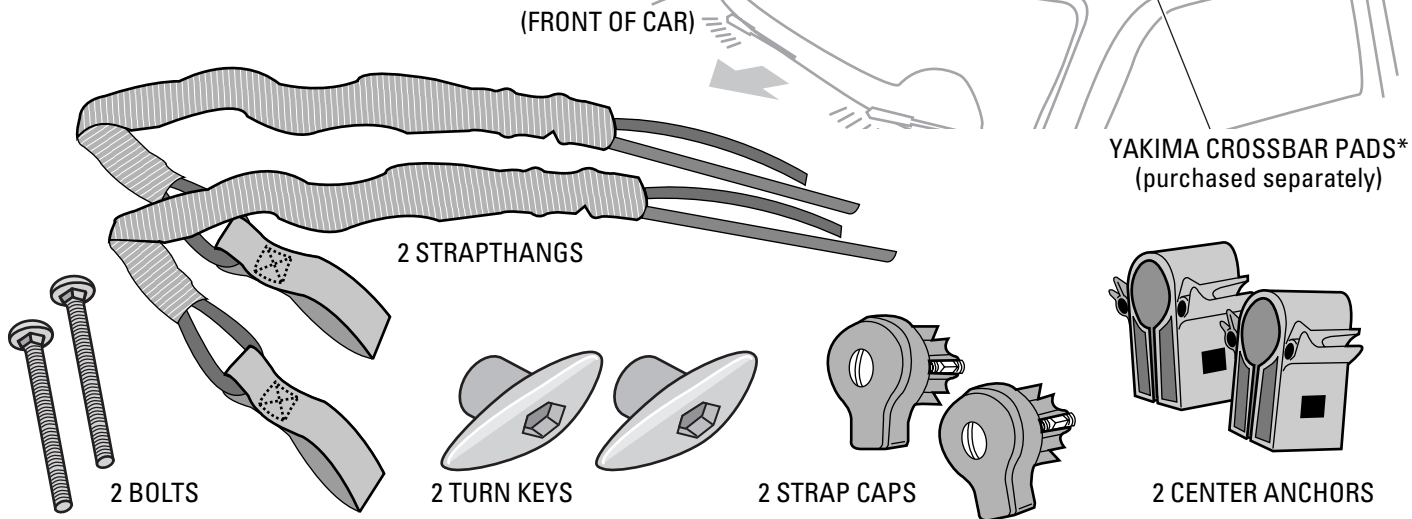

CROSSBAR OVERHANG

If you have several inches of crossbar overhang (A), strap may not reach the end cap with proper tension.

YOU MUST USE PADDING AND STRADDLE THE TOWER WITH YOUR BOARD (B) so that the strap can reach the end cap and remain tight.

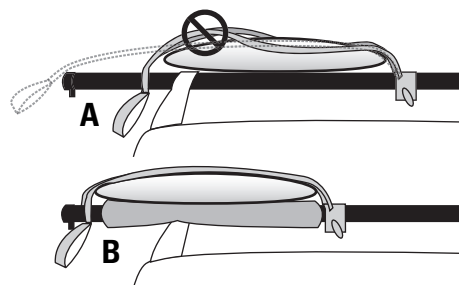

**We suggest you use Yakima Crossbar Pads (purchased separately) on the crossbars to take the bumps out of the road for your boards.*

If two boards are carried, we recommend the use of padding between the boards.

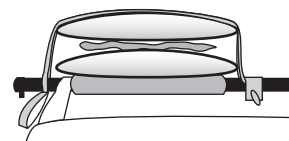

IMPORTANT WARNING

IT IS CRITICAL THAT ALL YAKIMA RACKS AND ACCESSORIES BE PROPERLY AND SECURELY ATTACHED TO YOUR VEHICLE. IMPROPER ATTACHMENT COULD RESULT IN AN AUTOMOBILE ACCIDENT, AND COULD CAUSE SERIOUS BODILY INJURY OR DEATH TO YOU OR TO OTHERS. YOU ARE RESPONSIBLE FOR SECURING THE RACKS AND ACCESSORIES TO YOUR CAR, CHECKING THE ATTACHMENTS PRIOR TO USE, AND PERIODICALLY INSPECTING THE PRODUCTS FOR ADJUSTMENT, WEAR, AND DAMAGE. THEREFORE, YOU MUST READ AND UNDERSTAND ALL OF THE INSTRUCTIONS AND CAUTIONS SUPPLIED WITH YOUR YAKIMA PRODUCT PRIOR TO INSTALLATION OR USE. IF YOU DO NOT UNDERSTAND ALL OF THE INSTRUCTIONS AND CAUTIONS, OR IF YOU HAVE NO MECHANICAL EXPERIENCE AND ARE NOT THOROUGHLY FAMILIAR WITH THE INSTALLATION PROCEDURES, YOU SHOULD HAVE THE PRODUCT INSTALLED BY A PROFESSIONAL INSTALLER SUCH AS A QUALIFIED GARAGE OR AUTO BODY SHOP.

TECHNICAL ASSISTANCE OR REPLACEMENT PARTS: Contact your dealer or call (888) 925-4621, Monday through Friday, 7:00 AM to 5:00 PM PST.

INSTALLING THE STRAP CAPS

- 1** REMOVE THE END CAPS FROM YOUR CROSSBARS.

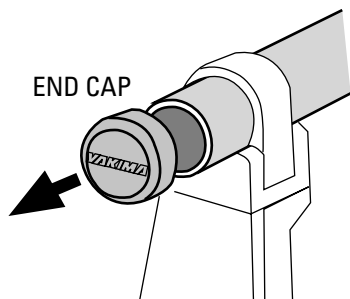

- 2** Firmly push a Strap Cap onto the end of each Crossbar.

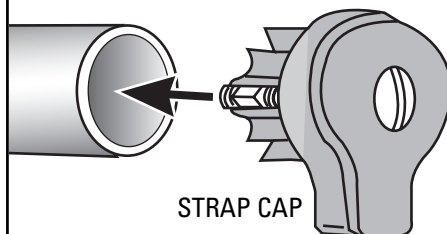

- 3** Using a screwdriver, tighten by turning the screw in each of the Strap Caps clockwise until the Cap is just secure.

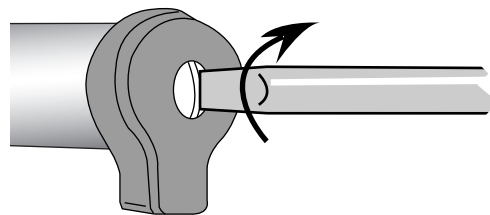

ATTACHING THE CENTER ANCHOR

- 4** PUSH THE CENTER ANCHOR ONTO THE MIDDLE OF THE CROSSBAR. (You will readjust it when your board is up there).

Push the bolt through and loosely attach the Turn Key.

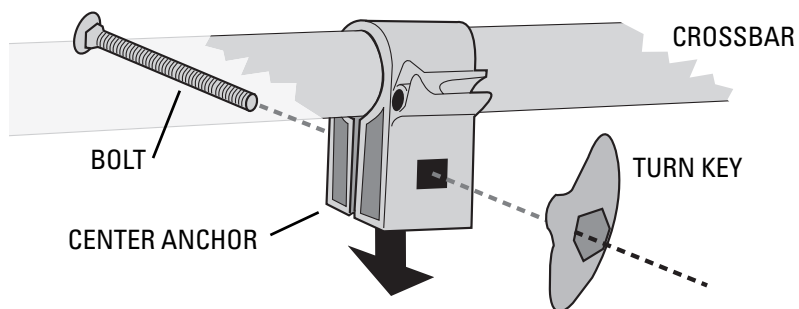

THREADING THE RUBBER CORD

- 5** SLIDE THE OPEN RUBBER LOOP OVER THE STRAP CAP.

- Insert one rubber cord into hole as shown.

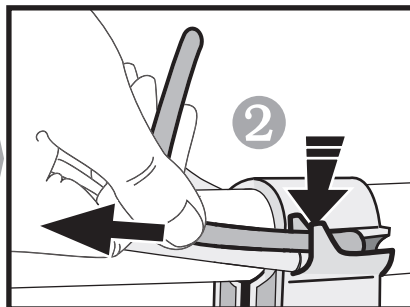
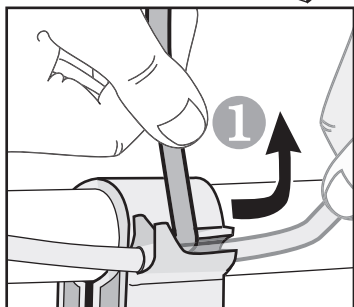
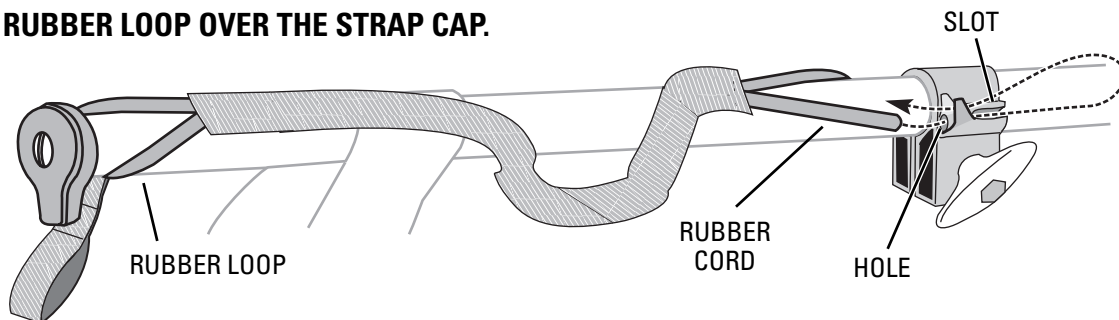

- Pull cord back firmly into slots, and push down securely into cinchers.
- Repeat with other cord.

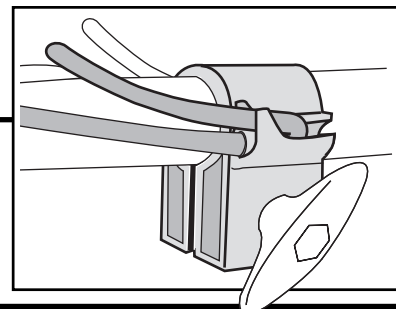

FAILURE TO PULL CORD BACK FIRMLY INTO SLOTS, AND PUSH DOWN SECURELY INTO CINCHERS COULD CAUSE LOSS OF BOARD(S), PROPERTY DAMAGE, PERSONAL INJURY OR DEATH.

ADJUSTING THE RUBBER CORD WITH BOARD(S)

6 Unhook loop from the Strap Cap, and put your board on the crossbars.

- Slide the center anchor (if necessary) within a few inches of the board.
- Tighten the Turn Key firmly.
- Replace loop over Strap Cap.

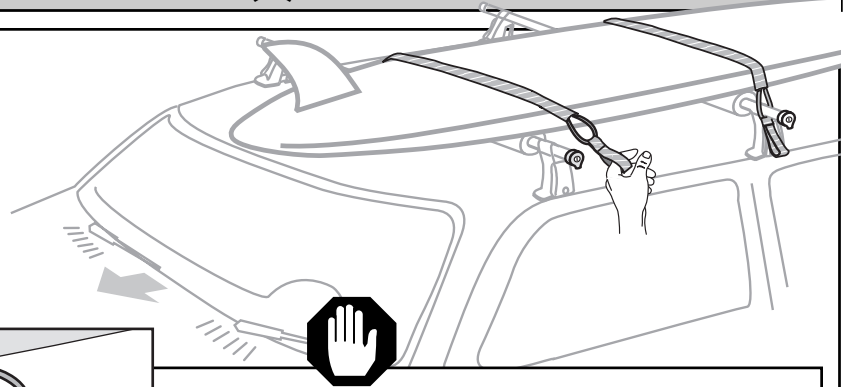
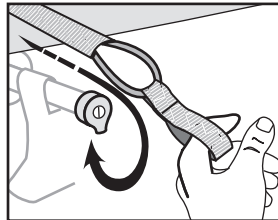
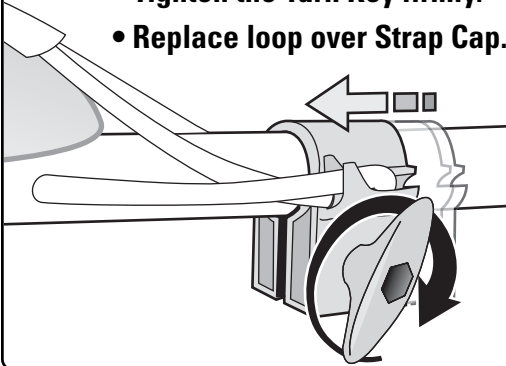

CARRY BOARDS WITH THE FINS FORWARD AND WITHIN 6" OF THE FRONT CROSSBAR. FINS MUST BE INSTALLED.

Check condition of the Rubber Cord and replace if worn.

7 THE RUBBER CORD SHOULD BE VERY TIGHT ACROSS THE SURFBOARD(S).

IF IT NEEDS ADJUSTING:

- Pull the end loop off of the Strap Cap.
- Pull both cords out of the cinchers.
- With the rubber cord free, move it in the desired direction. When the tension is adjusted correctly, pull cord tightly into the slot, and push each cord back into the cincher.
- Be sure the Rubber Cord is secure in the Cincher and tight across the surfboard(s) when the loop is pulled over the Strap Cap.

FAILURE TO SECURE CORD PROPERLY COULD CAUSE LOSS OF BOARD(S), PROPERTY DAMAGE, PERSONAL INJURY OR DEATH.

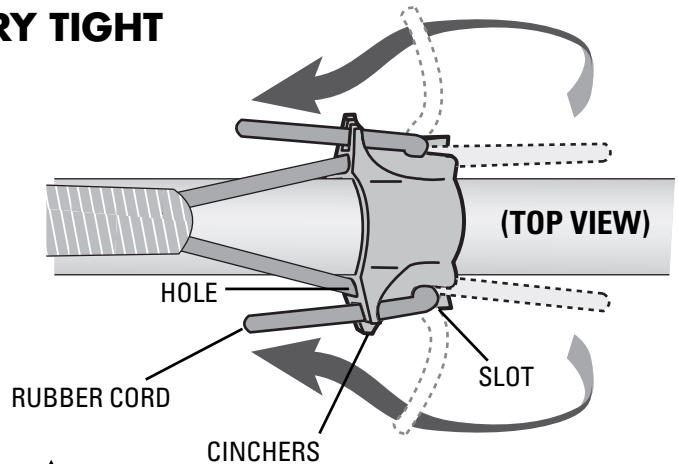

Cord must be pulled very tightly into slot and cinchers.

8 BEFORE DRIVING AWAY:

- Make sure the load is tight!
- Check to make sure the cord is pulled very tightly into slot and cinchers.
- After driving 15 minutes of travel, check to make sure the load is still tight!



WARNING: ATTACHMENT HARDWARE CAN LOOSEN OVER TIME. CHECK BEFORE EACH USE, AND TIGHTEN IF NECESSARY. FAILURE TO PERFORM SAFETY CHECKS CAN RESULT IN PROPERTY DAMAGE, PERSONAL INJURY, OR DEATH.

LIMITED WARRANTY: Yakima Products ("Yakima") will repair or replace merchandise which proves defective in materials and/or workmanship. The limited warranty is effective for three years from the date of purchase. The limited warranty is applicable only if the Fit List and instructions are followed and the products are used properly. If a customer believes that a Yakima product is defective, the customer must return it to an authorized Yakima dealer with proof of purchase. Yakima will then issue authorization to the dealer for the return of these products. If an article is found to be defective upon inspection by Yakima, Yakima will repair or replace the defective article at its discretion without charge. The customer will pay freight to Yakima, and Yakima will pay any applicable return freight. Unauthorized returns will not be accepted. Normal wear and tear of Yakima products or damage resulting from misuse, accidents, or alterations are not covered by this Limited Warranty. The purchaser acknowledges that Yakima has no control over the attachment of its products to vehicles or the attachment of items to the Yakima products. Accordingly, Yakima cannot assume responsibility for any damage to any property arising out of the improper attachment or use of its products. In addition, this Limited Warranty applies only to Yakima products and not to other products used in conjunction with Yakima products. This Limited Warranty is in lieu of all other warranties, expressed or implied, and does not cover consequential damages of any kind that may arise from the use or misuse of any Yakima product.