

MightyMount 18H

YAKIMA

MightyMounts replace SnapArounds for factory installed racks. Follow accessory instructions and use this reference sheet to attach your accessory.

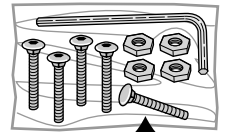
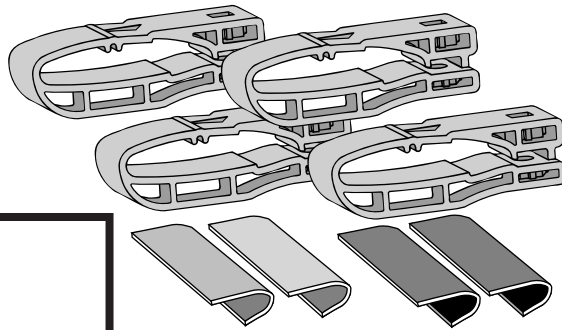

UPRIGHT BIKES:
Bolt for wheel tray.

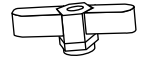

Use at rear of wheel tray with bolt.

1 PRESS the nuts firmly into each of the MightyMounts.

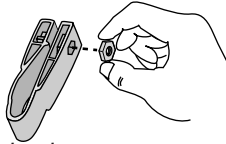

Bikes: Do not press nuts into the MightyMount at rear of wheel tray.

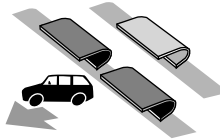
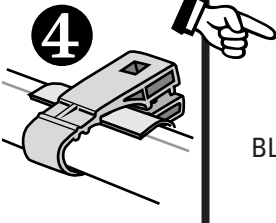
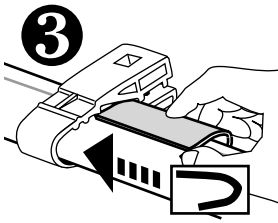
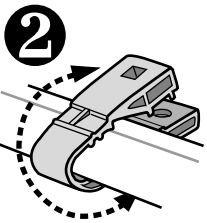

UPRIGHT BIKES:
BLACK caps must go on FRONT bars.

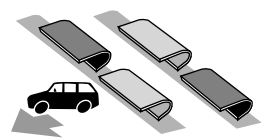

KAYAKS & BASKET CASES:
ALTERNATE the grey and black caps.

UPRIGHT BIKES

Which baseplate do you have?

Ridged Baseplate

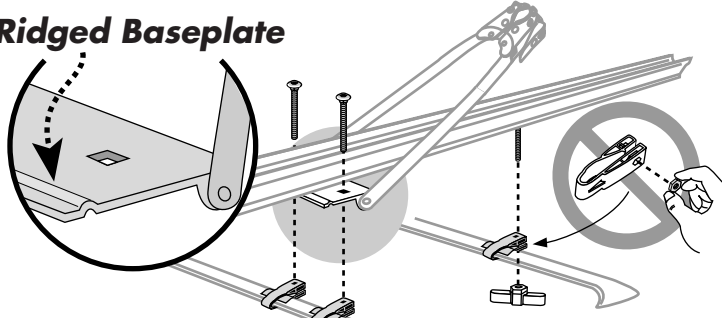

DO NOT press nuts into MightyMount at rear of wheel tray.

Angled Baseplate

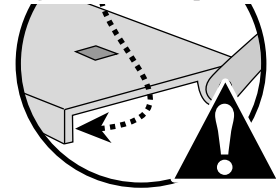

If you have this baseplate call us for the MightyMount Spacer Kit
Part #8820062

888-925-4621

BASKETCASE

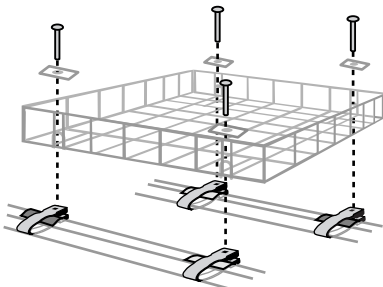

MAKO SADDLES

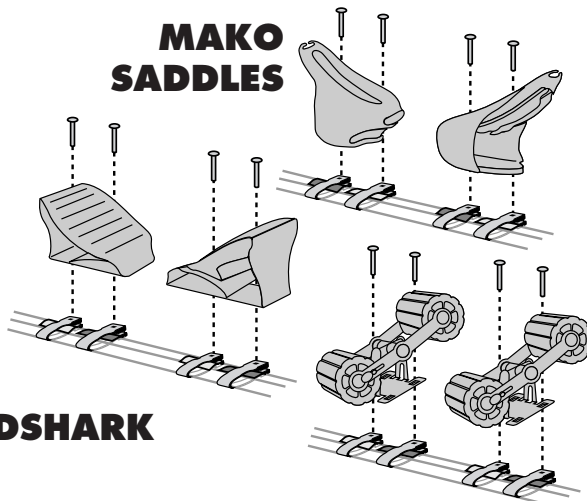

LANDSHARK

HULLY ROLLERS

KAYAK STACKERS

If you have this accessory call us for the Bolt Upgrade Kit
Part #8860007

888-925-4621

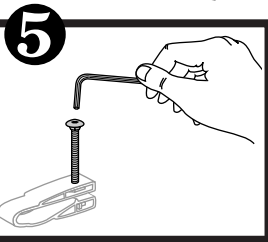
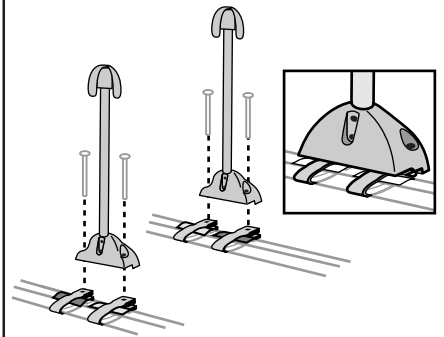

DO NOT EXCEED THE FACTORY WEIGHT LIMIT OF YOUR VEHICLE'S RACKS.



Secure front and rear of long loads to ends of vehicle for safe transport. Failure to do so can result in property damage, personal injury, or death.

MightyMount 18H ^{FR} YAKIMA

Les adaptateurs MightyMount remplacent les colliers Snaparound pour les porte-bagages installés à l'usine. Suivre les instructions accompagnant l'accessoire à installer et utiliser le présent feuillet de référence pour fixer votre accessoire.

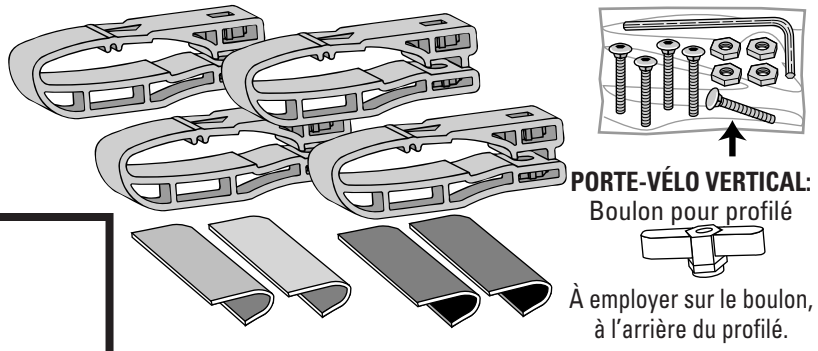

1 ENFONCER fermement un écrou dans chacun des adaptateurs MightyMount.
VÉLOS: Enlever l'écrou de l'un des adaptateurs (pour la barre arrière).

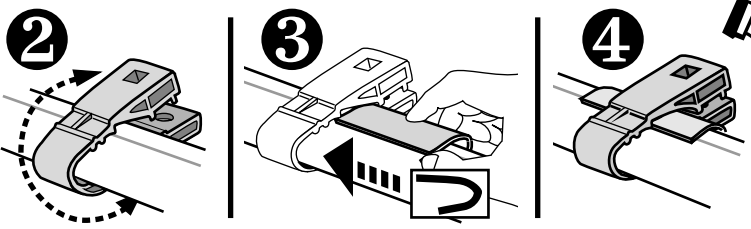

PORTE-VÉLO VERTICAL:
Poser les cales NOIRES sur la barre AVANT.

KAYAKS ET PANIER BASKETCASE:
ALTERNER les cales grises et noires.

PORTE-VÉLO VERTICAL
—
Quelle plaque d'articulation avez-vous?

Plaque d'articulation à arête

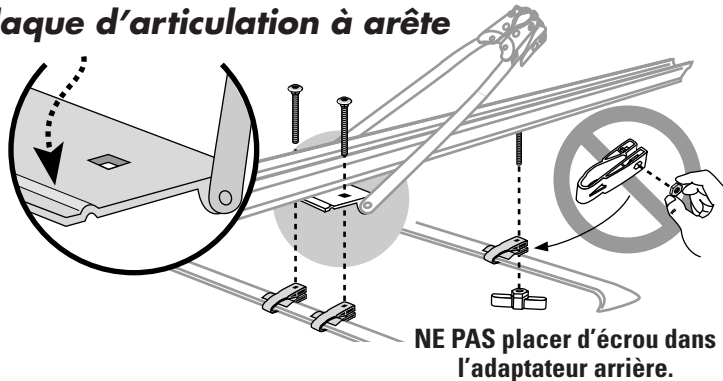

Plaque d'articulation à pliure

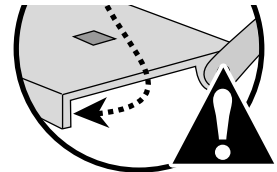

Si la plaque d'articulation à ce profil, appeler Yakima pour obtenir la trousse "Entretoises pour adaptateurs MightyMount" (article n° 8820062).
888-925-4621

BASKETCASE

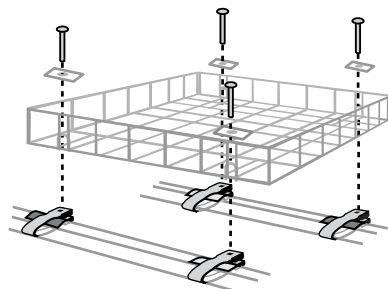

MAKO SADDLES

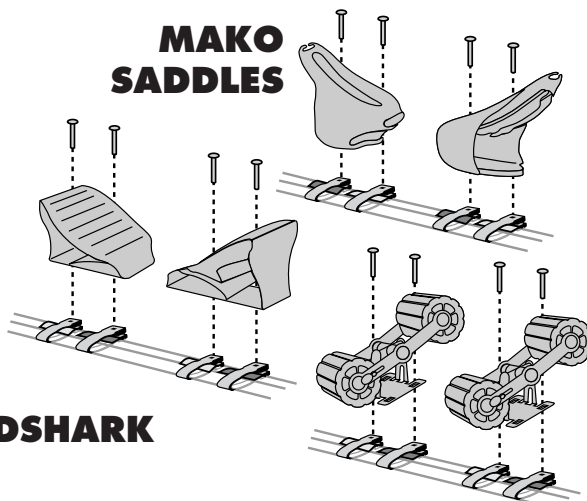

LANDSHARK

HULLY ROLLERS

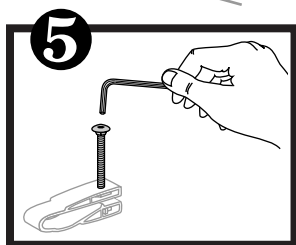

KAYAK STACKERS

Si vous avez cet accessoire, appeler Yakima pour obtenir la trousse "Boulons de remplacement - Sports aquatiques" (article n° 8860007)
888-925-4621

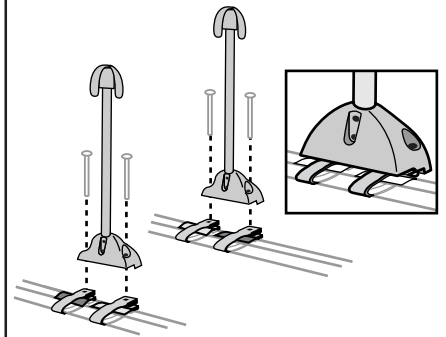

NE PAS DÉPASSER LA LIMITE DE CHARGE DU PORTE-BAGAGES!



Toujours attacher les charges longues à l'avant et à l'arrière du véhicule, afin de prévenir les risques d'accident, de blessure ou même de mort.