

# Shallow Well Jet Pumps for 4" Diameter Wells

## TYPICAL SHALLOW WELL PUMP INSTALLATION

**Note:** 1/3 HP and 1/2 HP motors are pre-wired for 115 volts. All other motors are pre-wired for

230 volts. The wiring may be converted to 115 volts; see instructions printed on motor.

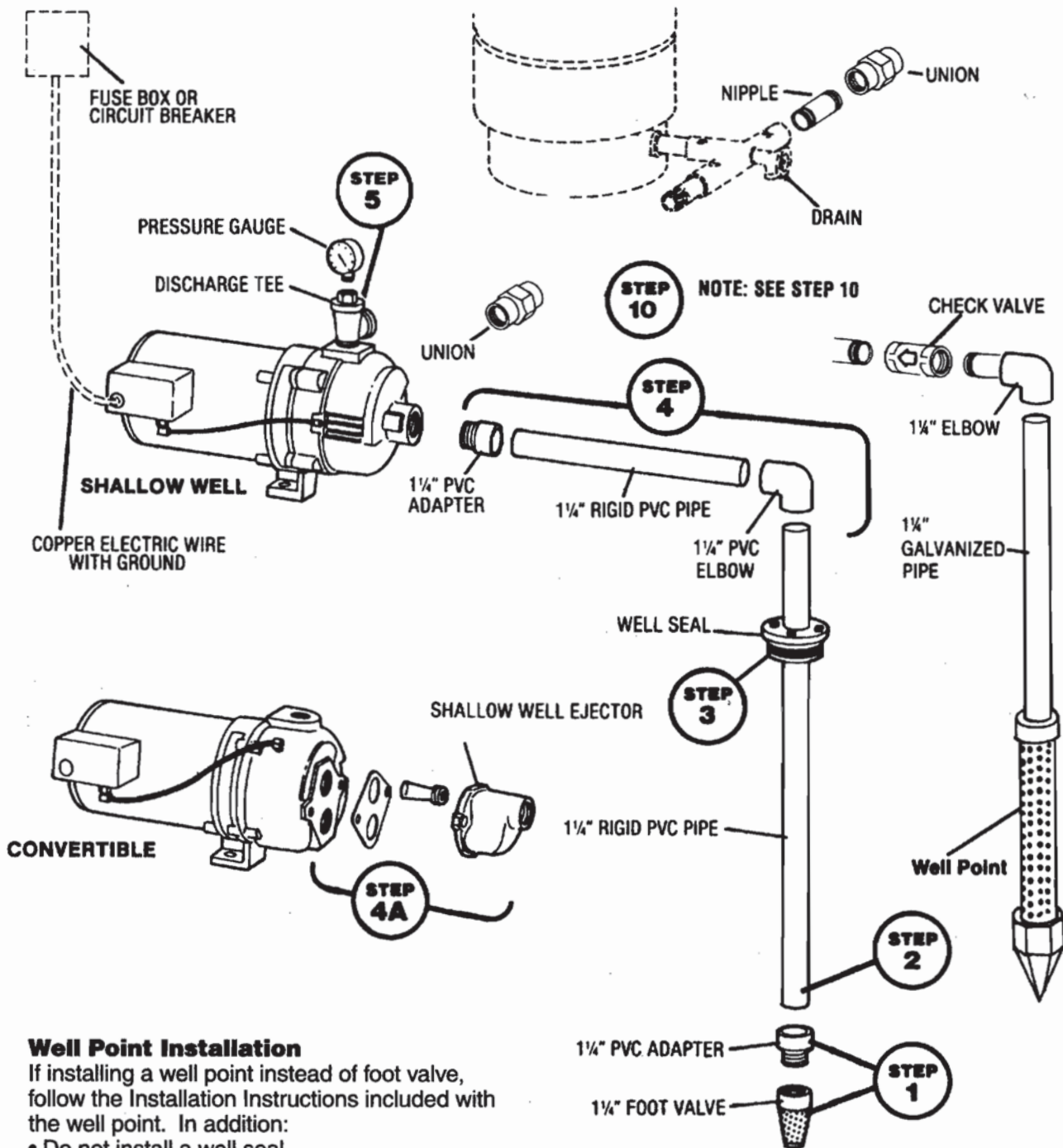

### Well Point Installation

If installing a well point instead of foot valve, follow the Installation Instructions included with the well point. In addition:

- Do not install a well seal.
- Install two check valves: one on the well side of the pump, and one on the house side. (See installation drawing.)