

Orbiter

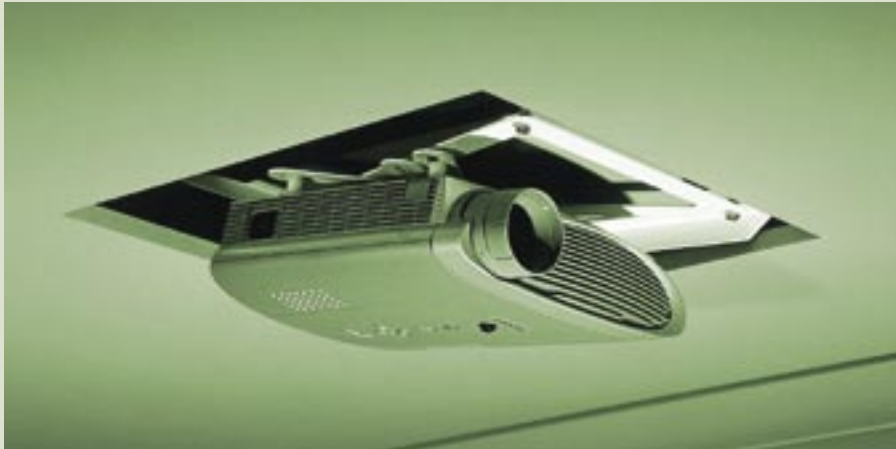

The ORBITER is an exciting new projector mounting solution. Its ingenious design allows the ORBITER to fit in small ceiling cavities and is the only lift that can be installed in an angled ceiling, making it uniquely versatile. The lift conceals your projector above the ceiling and quickly rotates it into the "show" position at the touch of a switch or wireless transmitter.

The ORBITER is supplied with a universal-style bracket that allows for easy attachment of a variety of projector models. The ORBITER can also be used for video conferencing cameras, speakers, etc.

Operated by optional IR or RF remote control, standard wall switch, or integrated into your control system, ORBITER will add a touch of class and sophistication to any room. The ORBITER motor is a DC-low voltage motor, 12V, which allows for easier control and wiring of the lift.

Options: Plenum housing, angled ceiling adapter, DC motor control (required for IR/RF/Serial/Network), 3-button up-stop-down switch

Orbiter Dimensions & Data

	Model A	Model B
Overall Size (w x l x h)	23" x 25 ⁹ / ₁₆ " x 14"	27" x 29 ¹ / ₂ " x 16"
Ceiling Panel Size (w x l)	19 ⁹ / ₁₆ " x 17 ³ / ₈ "	23 ⁹ / ₁₆ " x 21 ⁹ / ₁₆ "
Installation Height (without plenum)	14"	16"
Net Weight of Unit	33 lbs.	38 lbs.
Lifting Capacity	26 lbs.	26 lbs.
Maximum Projector Width	17"	20 ³ / ₄ "
Control Included	Wall Switch	Wall Switch
Control Options	IR or RF Remote	IR or RF Remote

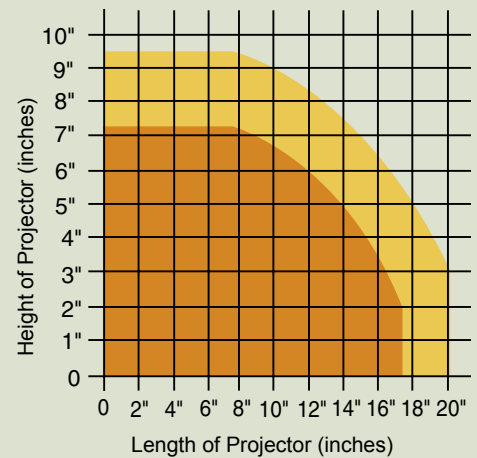

- A projector will fit into the Orbiter Model A if its dimensions are in the darkest area.
- A projector will fit into the Orbiter Model B if its dimensions are in the lightest area.

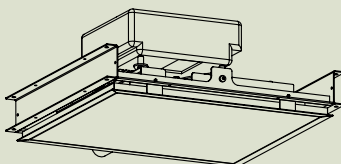
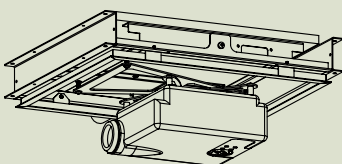

DRAPER