

**5" Apertures**  
**Lyte<sup>®</sup> Incandescent**  
**Non-IC Remodeler Frame-In Kit**

**Lytecaster<sup>®</sup>**  
**Recessed**  
**Downlighting**

**1003R**  
 C0101

TYPE:

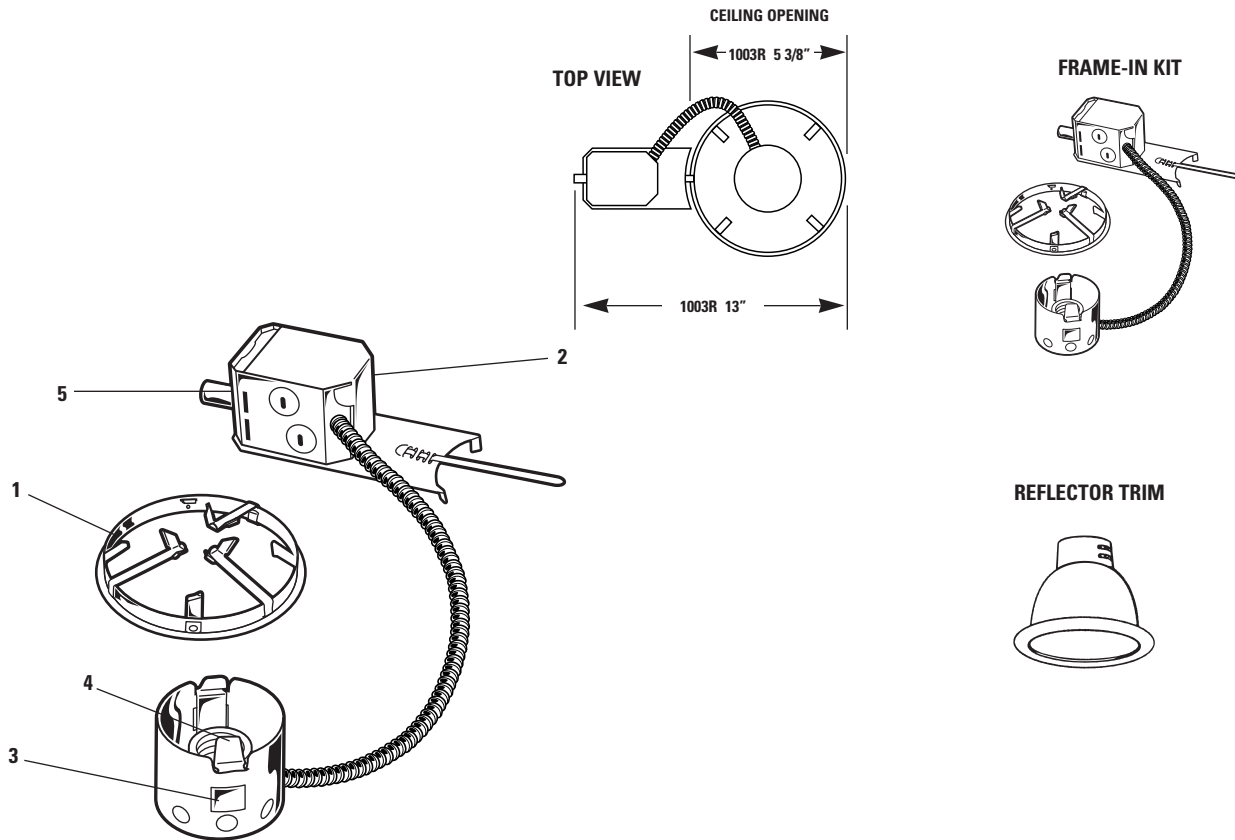

**5" APERTURE: Complete Fixture consists of Reflector Trim & Frame-In Kit. Select each separately.**

Reflector Trims - See individual Reflector Trim Specification Sheets.

Frame - In Kit	Open Downlight						Recessed Adjustable		Enclosed Diffusers	Wall Washer
	Alzak <sup>®</sup> Reflector	Alzak <sup>®</sup> Cone	Satin Cone	Baffles	Basic White	Pinhole				
<input type="checkbox"/> 1003R	<input type="checkbox"/> 1045	<input type="checkbox"/> 1012	<input type="checkbox"/> 1008	<input type="checkbox"/> 1005	<input type="checkbox"/> 1071	<input type="checkbox"/> 1011	<input type="checkbox"/> 1027	<input type="checkbox"/> 1038	<input type="checkbox"/> 1021	<input type="checkbox"/> 1035
	<input type="checkbox"/> 1046	<input type="checkbox"/> 1013	<input type="checkbox"/> 1010	<input type="checkbox"/> 1005WH			<input type="checkbox"/> 1027WH	<input type="checkbox"/> 1048	<input type="checkbox"/> 1024	<input type="checkbox"/> 1035WH
		<input type="checkbox"/> 1013BK		<input type="checkbox"/> 1076			<input type="checkbox"/> 1027BK		<input type="checkbox"/> 1078	<input type="checkbox"/> 1082
		<input type="checkbox"/> 1013WH		<input type="checkbox"/> 1076WH			Eyeball: <input type="checkbox"/> 1022 <input type="checkbox"/> 1023 <input type="checkbox"/> 1022WH <input type="checkbox"/> 1082			<input type="checkbox"/> 1085

**Features**

- 1. Mounting Ring:** .032 (#22 ga.) galvanized steel. Accommodates existing ceilings up to 2" thick. Attaches securely to any type of ceiling material without tools using (3) mounting straps provided. Push-in/twist-out clips hold reflector flush to ceiling. Includes adhesive backed aperture template.
- 2. Junction Box:** 2 1/2" X 2 1/2" X 3 1/2" (21 cu. in.) .032 (#22 ga.) galvanized steel. U.L. listed for 90° C supply wire. Integral cable clamps permit attachment of non-metallic (#12 or #14 ga.) Romex<sup>®</sup> cable without tools or additional connectors. Attaches to mounting ring without tools.
- 3. Socket Housing:** Impact extruded aluminum or galvanized steel.

- 4. Socket:** Porcelain medium base; nickel plated screw shell. Pre-wired with #18 ga. SF1 (300 VOLT 200° C) leads to junction box.
- 5. Thermal Protector:** Meets NEC and U.L. requirements. Do not install insulation within 3 inches of fixture sides or wiring compartment nor above fixture in such a manner as to entrap heat.

**Options & Accessories**

**Thermal Protector Replacement:** 1970  
**Replacement Clips (Set of 3):** 1997

**Labels**

U.L.(Suitable for Damp Locations);U.S.+Foreign Patents Pending.

WE RESERVE THE RIGHT TO CHANGE DETAILS OF DESIGN, MATERIALS, AND FINISH.

Alzak<sup>®</sup> is a registered trademark of The Aluminum Company of America. Romex<sup>®</sup> is a registered Trademark of General Cable Industries Inc.

**LIGHTOLIER a GENLYTE THOMAS company.**  
 631 Airport Road, MA 02720  
 (508) 679-8131 • Fax (508) 674-4710

Copyright 2001

**LIGHTOLIER**