

## Silver Series™ 2-Flavor

### Gourmet Cold Beverage System with Fully Lighted Graphics



#### Model JDF-2S w/Lighted Graphics

(available with iced coffee or juice display)  
Dimensions: 33.1"H x 10"W x 25.5"D  
(84.1 cm H x 24.9 cm W x 64.8 cm D)

### Features

#### Gourmet Cold Beverage System

*Cold beverage dispenser with patented High Intensity® mixing delivers superior drinks consistently glass after glass*

- Fully lighted door graphics bring high visibility to front-of-house applications.
- One dispenser delivers both frozen and ambient products increasing profits by lowering costs.
- Drink consistency assured with the BUNN patented High Intensity® mixing technology.
- Pumps and mixes 2+1 to 11+1 concentrated beverages, including 4+1 high viscosity and 5+1 juices accurately and consistently.
- Quick dispense with 1.0 to 1.5 ounces (29.6 to 44.4 ml) per second flow rate.
- 7" cup clearance accommodates most juice containers.
- 8 lb. (3.6 kg) ice bank provides superior cold drink capacity.
- Advanced concentrate pump designed for easy setup, accuracy and durability.
- Modular dispense deck makes service fast and simple.
- Both push-button and single-size portion control in the same machine.
- Available with Iced Coffee or Juice display.
- Preventive maintenance kit: 39690.0000. 

For current specification sheets and other information, go to [www.bunn.com](http://www.bunn.com).

### Related Products

**Easy Clear® EQHP-10**  
Product No. :39000.0004



**Easy Clear® EQHP-10CRTG**  
Product No. :39000.1004

**Ambient Conversion Kit**  
Product No.: 33699.0001  
(one kit required per dispense station - photo shows 4-dispense station unit with one container and three ambient conversion kits)



**Refillable Juice Container**  
Capacity: 1 Gallon  
Product No.: 39302.0000



**Model**

**Agency Listing**

JDF-2S



**Patents Apply**

**11/08**

**D6.1a**

## Dimensions & Specifications

Model	Product #	Volts	Amps	Capacity	Cubic Measure	Shipping Weight	Cord Attached
JDF-2S, Lit Door <i>(juice display)</i>	37900.0008	120	4.5	4 (5 oz.) drinks/min*	10.3 ft <sup>3</sup>	103 lbs.	Yes†
JDF-2S, Lit Door <i>(iced coffee display)</i>	37900.0009	120	4.5	4 (5 oz.) drinks/min*	10.3 ft <sup>3</sup>	103 lbs.	Yes†
JDF-2S, Lit Door <i>(dual dispense - allows simultaneous dispense from both dispense heads, juice display)</i>	37900.0027	120	4.5	4 (5 oz.) drinks/min*	10.3 ft <sup>3</sup>	103 lbs.	Yes†

Refillable Juice Container Product No.: 39302.0000 Capacity: 1 Gallon

\* 75°F (24°C) incoming water for 180 drinks without exceeding 41°F (5°C) finished drink temperature.

†Power cord (NEMA 5-15P) 15 Amp-120V machine only.

Electrical: Model requires 2-wire grounded service rated 120V, single phase, 60 Hz.

Plumbing: 20-100 psi (138 - 690 kPa). Machine supplied with  $\frac{3}{8}$ " (0.95 cm) male fitting.

Refrigeration: R-134a refrigerant, 9 oz. (.28 kg), 8 lb. (3.6 kg) ice bank system

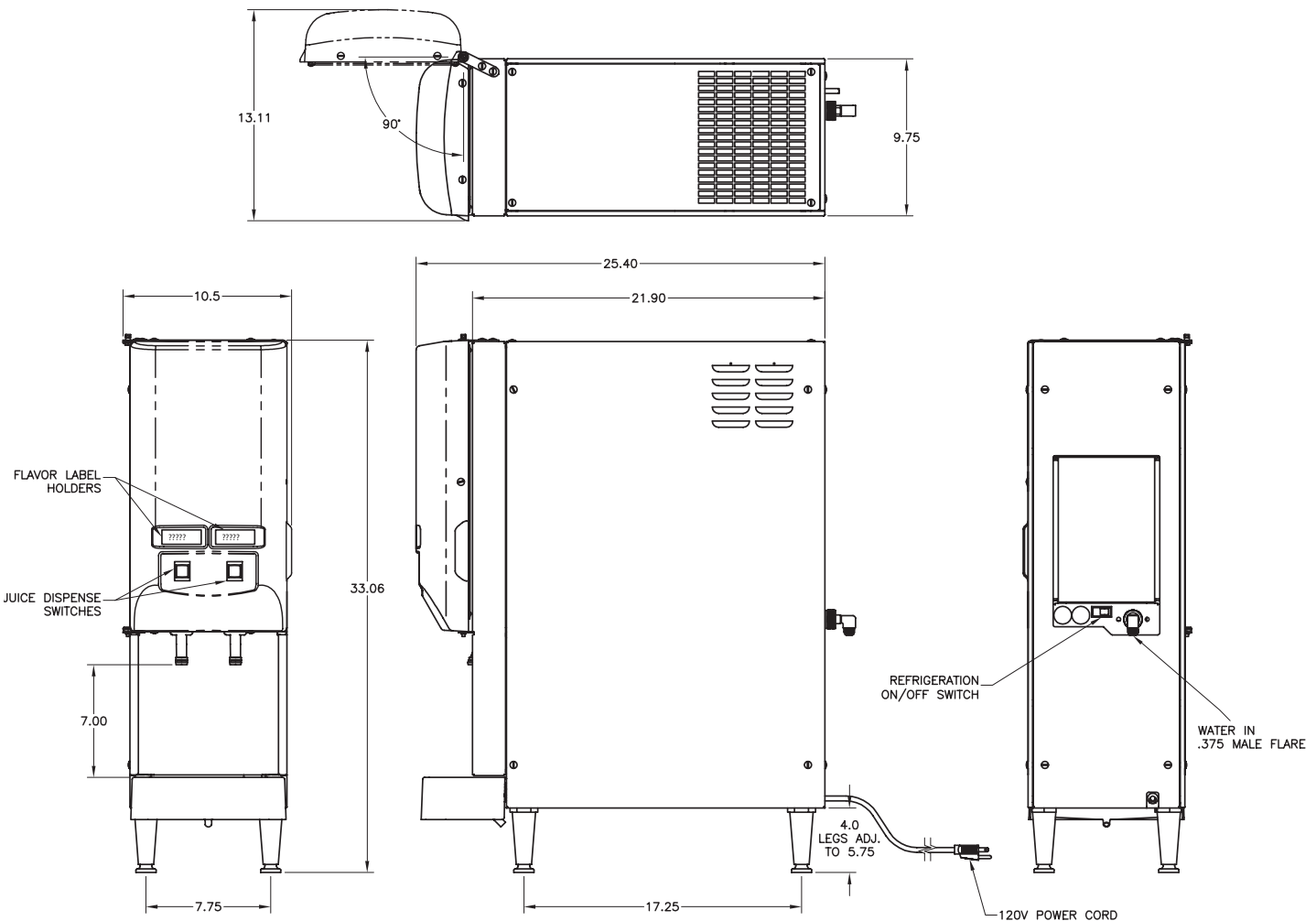

Bunn-O-Matic® Corporation - 1400 Stevenson Drive Springfield, Illinois 62703 • 800-637-8606 • 217-529-6601 • Fax 217-529-6644 • www.bunn.com

BUNN® practices continuous product research and improvement. We reserve the right to change specifications and product design without notice. Such revisions do not entitle the buyer to corresponding changes, improvements, additions or replacements for previously purchased equipment.

All dimensions shown in inches.

11/08 © Bunn-O-Matic Corporation