

## Twin 3 Gallon Iced Tea Brewer



### Model TB6Q with (2) TDO-N-3.5 Dispensers

(dispensers sold separately)

Dimensions: 34" H x 12.2" W x 22.6"D  
(86.4cm H x 30.9cm W x 57.4cm D)

### Features

#### Twin 3 Gallon Iced Tea Brewer

*Twin 3 Gallon Iced Tea Brewer brews large volumes of two types of fresh iced tea into separate space-saving dispensers*

- Brews 16.3 to 26.7 gallons (61.7 to 101.1 litres) per hour from real tea leaves.
- Meet your volume needs; brew 3 gallons (11.4 litres) of iced tea into each dispenser and serve up to 6 gallons (22.7 litres) within a narrow footprint.
- Specifically designed to accommodate and brew into two BUNN 3.5 gallon Narrow Tea Dispensers (can also brew directly into standard tea dispensers).
- Includes rotating brew basket, base platform adapter, dedicated dilution nozzles and brew selection switch.
- Color coded decals help the operator properly align the brew basket, dispenser and choose the correct selection.
- Quickbrew (Q) model available for shorter brewing cycles.
- SplashGard® funnel deflects hot liquids away from the hand.
- TB6 has adjustable steep time for more control over flavor extraction.

For current specification sheets and other information, go to [www.bunn.com](http://www.bunn.com).

### Related Products

**Easy Clear® EQHP-Tea**  
Product No. : 39000.0007



**Easy Clear® EQHP-TEACRTG**  
Replacement Cartridge  
Product No. : 39000.1007

**Single/Dual Filter Pack**  
Product No. : 20100.0000  
Packed per case: 500  
Dimensions: 5 1/4" Base x 3 3/4" Sidewall  
13.34 cm Base x 9.52 cm Sidewall



**TDO-N-3.5 – Tea Dispenser**  
Product No. : 39600.0001  
Capacity: 3.5 gallons  
Weight: 12.3 lbs.  
Dimensions:  
21.6" H x 6.2" W x 13.5" D  
59.4cm H x 15.7cm W x 34.3cm D



**TB6 Funnel**  
Product No. : 03021.0013

**TB6Q Funnel**  
Product No. : 03021.0014

**TD4T – Dual Reservoir Tea Dispenser**  
Product No. : 03250.0032  
Capacity: 4 gallons  
Weight: 14.5 lbs.  
Dimensions:  
22" H x 9.1" W x 15.7" D  
55.9cm H x 23.1cm W x 39.9cm D



#### Model

#### Agency Listing

TB6



TB6Q



## Dimensions & Specifications

Model	Product #	Volts	Amps	Tank Heater Watts	Total Watts	Brewing Capacity	Cubic Measure	Shipping Weight	Cord Attached
TB6	36700.0300	120	14.4	1680	1730	16.3 gal./hr.	8.8 ft <sup>3</sup>	43 lbs.	Yes†
TB6Q	36700.0301	120	14.4	1680	1730	26.7 gal./hr.	8.8 ft <sup>3</sup>	43 lbs.	Yes†

†Power cord (NEMA 5-15P) 15 Amp-120V machine only.

Electrical: Models require 2-wires plus ground service rated at 120V, single phase, 60 Hz.

Plumbing: 20-90 psi (138-621 kPa). Machine supplied with 1/4" OD male flare fitting. Requires minimum of 1 gpm water flow.

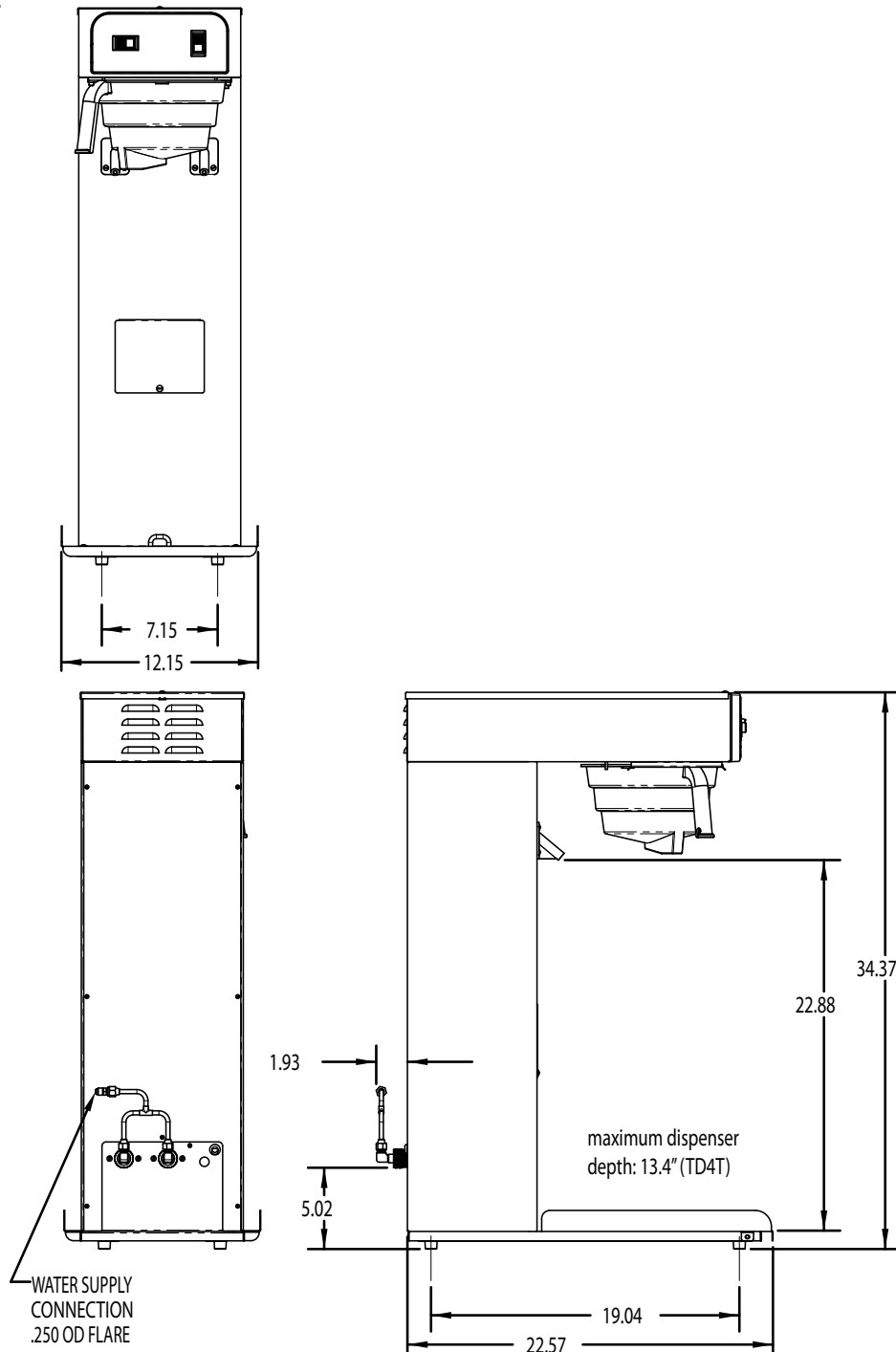

Bunn-O-Matic® Corporation - 1400 Stevenson Drive Springfield, Illinois 62703 • 800-637-8606 • 217-529-6601 • Fax 217-529-6644 • www.bunn.com

BUNN® practices continuous product research and improvement. We reserve the right to change specifications and product design without notice. Such revisions do not entitle the buyer to corresponding changes, improvements, additions or replacements for previously purchased equipment.

All dimensions shown in inches.