

# Model CSD1X2 Ceiling Drop-In Speaker

## 70V & 25V Speaker Systems

**BOGEN®**

Meets the conditions of acceptance of the UL-2043 test standard.

### Electrical Connection

1. Remove electrical box cover, then install cable clamp and feed cable into the electrical box.
2. Connect feed wires to speaker leads— to ensure all speakers are correctly phased, be certain to connect the same color speaker lead to the same polarity amp feed wire for all speakers within the system.
3. Secure all mechanical connections and re-install the electrical box cover.
4. Set tap selector switch to proper tap setting.

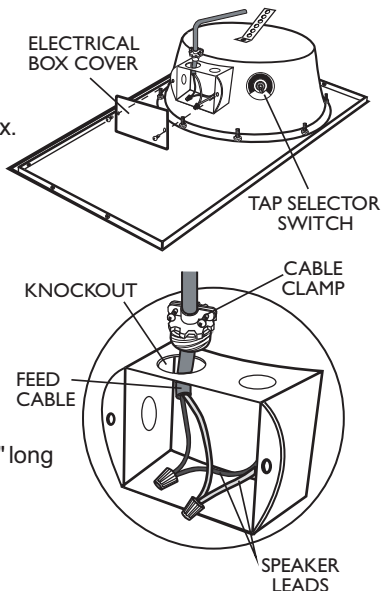

### Ceiling Installation

1. For 2ft. X 4ft. tile space, cut ceiling tile to 35-1/2" long or for a 2ft. X 2ft. tile space, cut to 11-1/2" long.
2. Place speaker in ceiling with the tile support lip facing the ceiling tile opening.
3. Drop in the tile.

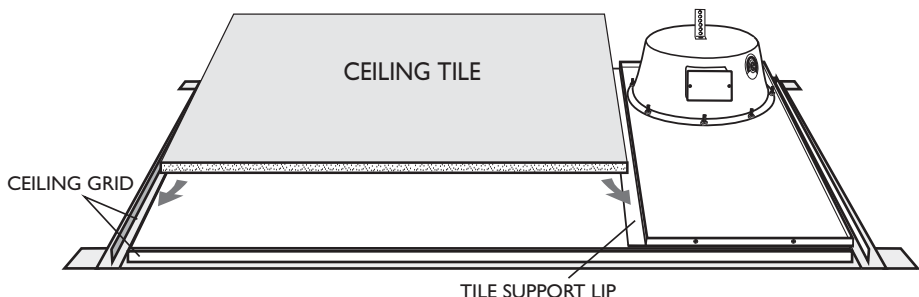

### 2-YEAR WARRANTY

The CSD1X2 is warranted to be free from defects in material or workmanship for two (2) years from the date of sale to the original purchaser. This warranty does not extend to any of our products that have been subjected to abuse, misuse, improper storage, neglect, accident, improper installation or have been modified or repaired or altered in any manner whatsoever, or where the serial number or date code has been removed or defaced.

**BOGEN®**  
**COMMUNICATIONS, INC.**

50 Spring Street, Ramsey, NJ 07446, U.S.A.  
Tel. 201-934-8500, Fax: 201-934-9832, [www.bogen.com](http://www.bogen.com)  
Specifications subject to change without notice  
© 2004 Bogen Communications, Inc.  
53-2070-01C