

ALEX®

# CERAMIC SWIRL ART

Contains:

- Art Spinner
- Splash Shield
- 5 Bottles of Paint
- 4 Plates
- 2 Tiles with Holes
- 2 Solid Tiles
- 3 Colors of Ribbon
- 4 Plate Stands

## GET READY!

Establish a work area that is large enough for you to work comfortably. You'll need something to protect your work surface (an ALEX® Drop Cloth or newspaper works well). You'll also need a damp cloth for clean up.

Assemble your Art Spinner as shown.

Be sure to push the Spinner Plate down snugly!

The Spinner requires two AA-size (LR6) batteries (not included).

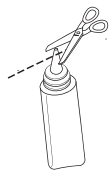

Have an adult help you snip the tips off the paint bottles with scissors. Be careful not to cut too low!



**CAUTION! Paint is permanent and may stain. Please protect your clothing and work area!**

## GET SET!

Place a plate or tile in the middle of your Spinner. Screw the orange knob snugly to your ceramic piece.

Place the splash guard onto the machine. Now turn on your Spinner and let it get up to full speed.

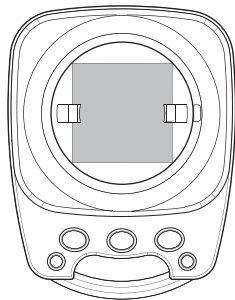

**CAUTION:  
DO NOT STICK  
YOUR FINGERS IN  
THE SPINNER WHILE  
IT'S RUNNING!**

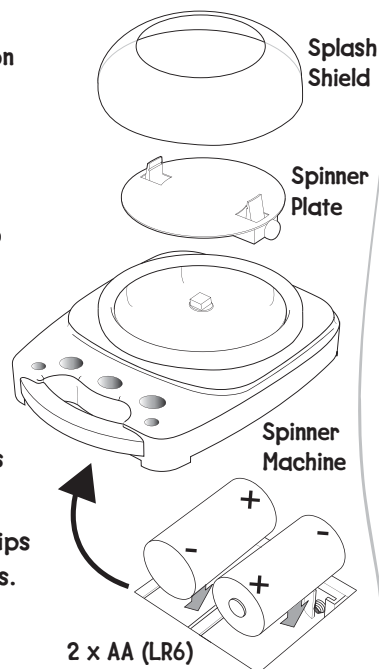

Now you're ready to create fun art!

Squeeze drops of paint onto the spinning tile or plate. Add as many colors as you want! Try adding the colors at different times to create different layers of color.

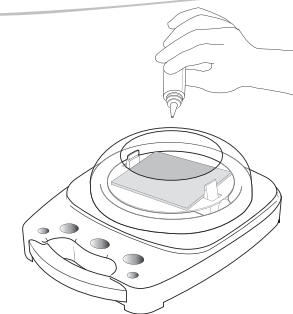

Turn off the Spinner and allow the machine to come to a **COMPLETE STOP!**  
**DO NOT STICK YOUR FINGERS IN THE SPINNER WHILE IT'S RUNNING!**

Remove the Splash Shield to take out your fantastic work of art! Allow it to dry for 1 hour. Remember to recap the paint so the tips won't clog.

Cleaning Instructions: Wipe off the motorized base with a damp cloth between each use. **DO NOT IMMERSE IN WATER!**

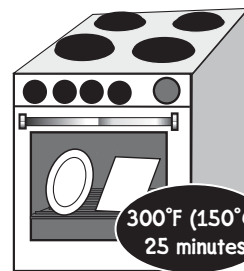

## GO!

Bake your plates and tiles to set the paint. This allows you to hand-wash them without the paint peeling off.



## WARNING!

**Adult Supervision is required to operate oven!**

After you have left your ceramic items to dry for 1 hour, place them into a preheated oven at 300°F (150°C) and bake for 25 minutes. You may notice a slight smell while baking. This is normal and will disappear quickly.

Next, turn off the oven and leave the oven door partially open. **DO NOT** remove the items immediately! Allow them to cool for one hour. Afterwards, ask an adult to remove them from the oven.

Do not wash your plates and tiles in a dishwasher. Hand-wash only with a mild detergent and a soft cloth.

Display your creations on the included plate stands! Thread ribbon through the holes of the tiles to hang them!

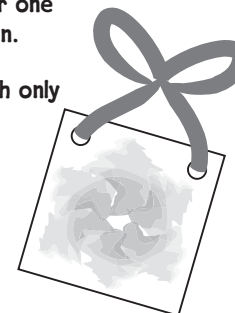

- Insert batteries as shown.
- Use only the same or equivalent type battery as shown.
- Do not mix old and new batteries.
- Do not mix batteries of different types (alkaline, carbon-zinc, and rechargeable).
- Remove exhausted batteries from toy.
- Do not charge non-rechargeable batteries.
- Do not short circuit supply terminals.
- Remove rechargeable batteries before charging.
- Rechargeable batteries are only to be recharged under adult supervision.

#166W

©2005 ALEX: Northvale, NJ 07647  
Visit our web site at [www.alextoys.com](http://www.alextoys.com)